

FEATURES

Sizes: ☐ 2 1/2" ☐ 3" ☐ 4"
☐ 6" ☐ 8" ☐ 10"

Pressure rating 200 psi WOG
125 psi WSP
Temperature rating 33°F to 350°F
Connections Flanged ANSI B16.1
Class 125

OPTIONS

(Suffixes can be combined)

- ☐ - reduced port (8" & 10" only)
- ☐ - with gear operator (8" & 10" only)

APPLICATION

WILKINS Model 850 Full Port Cast Iron Ball Valves are recommended for residential, commercial and industrial applications. Ideal for throttling and balancing installations of low pressure steam, air, water and non-corrosive gas or oil. Quarter turn handle activated.

STANDARDS COMPLIANCE

- ☐ Meets Federal Specification WW-V-35B Type II, Class A, Style B

MATERIALS

Main valve body	Cast Iron ASTM A 126
Ball	Cast Iron ASTM A 126
	Teflon coated
Stems	Stainless steel, 300 series
Stem packing	Reinforced PTFE
Handle	Zinc plated steel
Handle bracket	Ductile Iron
Fastners	Carbon steel

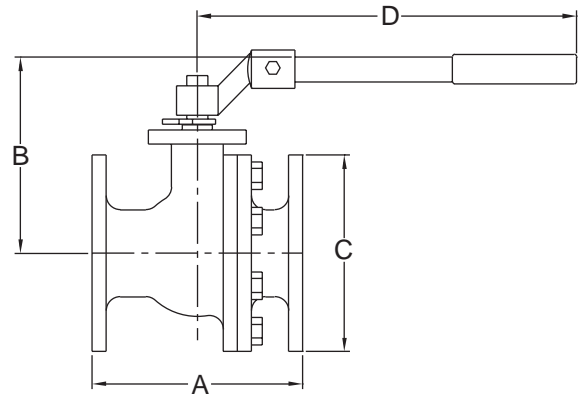

DIMENSIONS & WEIGHTS (do not include pkg.)

SIZE	DIMENSIONS inches (approximate)				PORT DIAMETER	BOLT HOLES	WEIGHT lbs.
	A	B	C	D			
2 1/2	7 1/2	7	7	13 1/2	2 1/2	4	36
3	8	7 1/2	7 1/2	13 1/2	3	4	46
4	9	8 1/2	9	15 1/2	4	8	75
6	10 1/2	13	11	30	6	8	131
8	11 1/2	13	13 1/2	30	6	8	185
10	13	15	16	33	8	12	276

DOCUMENT NO. BV-850(LG)	REV. 10/99
----------------------------	---------------