

Model DUSPC

Double Union Spacer Nipple
for Temporary System By-pass



FEATURES

Sizes: ☐ 3/4" ☐ 1" ☐ 1 1/4"

Maximum working water pressure 200 PSI
Maximum working water temperature 180°F
End connections threaded ANSI B1.1

ACCESSORIES

- ☐ Stainless steel screen (SCR)
- ☐ Spacer nipple with union tailpiece assembly (SPK)

APPLICATION

Designed for installation on potable water systems as a temporary by-pass prior to installation of the Model BR4 and Model 70DU Water Pressure Reducing Valves. Allows system to be inspected for leaks and allowable pressure loss. Optional stainless steel screen provides protection against sediment and debris.

MATERIALS

Body High impact PVC
Strainer screen 300 series stainless steel

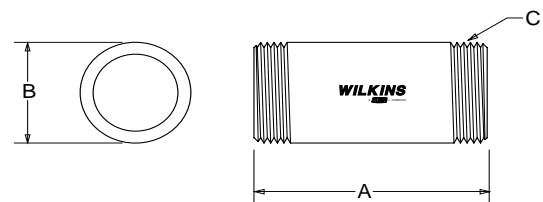

DIMENSIONS & WEIGHTS (do not include pkg.)

PART NO.	FOR MODEL	DIMENSIONS (approximate)					WEIGHT	
		A		B		C	lbs.	kg.
34-70DUSPC	3/4" 70DU	4 1/4	108	1 3/4	45	1 1/2-12 UNF	1	0.50
34-BR4DUSPC	1/2" & 3/4" BR4	3 1/2	89	1 11/16	43	1 1/2-12 UNF	1	0.50
1-70DUSPC	1" 70DU & BR4	4	102	1 7/8	48	1 3/4-12UN	1	0.50
114-70DUSPC	1 1/4" 70DU	6	152	2 3/8	60	2 3/16-12UNS	1	0.50
114-BR4DUSPC	1 1/4" BR4DU	5 1/16	129	2 3/8	60	2 3/16-12UNS	1	0.50

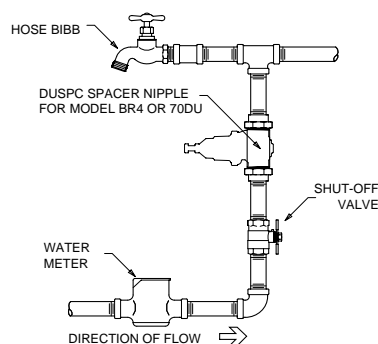

OUTDOOR INSTALLATION

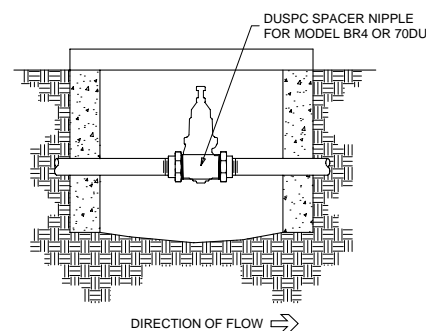

PIT INSTALLATION

SPECIFICATION

The double union spacer nipple shall be constructed of PVC. The end connections shall be threaded and allow for full pipe capacity. The end to end dimension shall be equal to the corresponding regulator end to end dimension. An optional strainer screen shall be available where dirt and debris could cause damage to system. The double union spacer nipple shall be a WILKINS Model DUSPC.

DOCUMENT NO. REG-DUSPC	REV. 10/99
----------------------------------	----------------------