

Model DU, DUC AND DUM

Dielectric Pipe Fittings

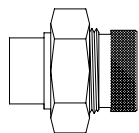

MODEL DU

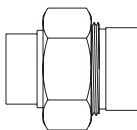

MODEL DUC

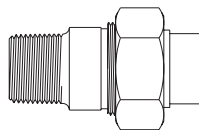

MODEL DUM

FEATURES

Sizes: ☐ 1/2" ☐ 3/4" ☐ 1" ☐ 1 1/4"
☐ 1 1/2" ☐ 2" ☐ 2 1/2" ☐ 3"

Maximum working water pressure 250 PSI
Maximum working water temperature 180°F
Thread connections ANSI B 1.20.1
Copper connections ANSI B 16.22

OPTIONS

- ☐ HT - high temp applications (300°F @ 50 psi)
- ☐ DUBI - black iron oxide coating (female iron pipe by female iron pipe)

APPLICATION

Designed for installation on potable water lines to protect against piping system deterioration caused by galvanic and stray current corrosion. A dielectric fitting is necessary where dissimilar metals are used in piping systems.

MATERIALS

Body & flanges Steel w/Galvanized Coat
Bolts & nuts Steel w/Galvanized Coat
Tailpiece Brass
Insulator Nylon
Gaskets EPDM (Standard)
Viton (High Temp)

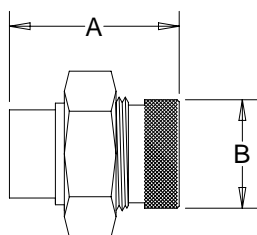

MODEL DU & DUBI

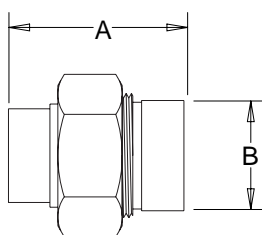

MODEL DUC

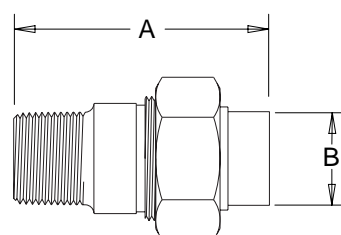

MODEL DUM

DIMENSIONS & WEIGHTS

FEMALE IRON PIPE BY COPPER SOLDER JOINT					
PART NUMBER	DIMENSIONS (INCHES)				WEIGHT (LBS)
	INLET SIZE	OUTLET SIZE	A	B	
12-DUC	1/2"	1/2"	1.50	1.88	0.5
34-DUC	3/4"	3/4"	1.63	2.13	0.5
34-DU12C	3/4"	1/2"	1.63	2.13	0.5
1-DUC	1"	1"	1.88	2.50	0.5
114-DUC	1 1/4"	1 1/4"	2.25	3.00	1.3
112-DUC	1 1/2"	1 1/4"	2.75	3.00	2.0
2-DUC	2"	2"	3.50	3.00	2.3
212-DUC	2 1/2"	2 1/2"	3.00	6.00	13.5
3-DUC	3"	3"	3.00	7.00	16.5

FEMALE IRON PIPE BY FEMALE BRASS PIPE					
PART NUMBER	DIMENSIONS (INCHES)				WEIGHT (LBS)
	INLET SIZE	OUTLET SIZE	A	B	
12-DU	1/2"	1/2"	1.63	2.25	0.5
34-DU	3/4"	3/4"	1.88	2.25	0.8
1-DU	1"	1"	2.25	2.50	1.0
"FLANGED" FEMALE IRON PIPE BY FEMALE IRON PIPE					
212-DU	2 1/2"	2 1/2"	5.88	2.75	12.0
3-DU	3"	3"	6.75	2.75	15.0
MALE IRON PIPE BY COPPER SOLDER JOINT					
PART NUMBER	DIMENSIONS (INCHES)				WEIGHT (LBS)
	INLET SIZE	OUTLET SIZE	A	B	
12-DUM	1/2"	1/2"	1.50	2.63	0.5
34-DUM	3/4"	3/4"	1.63	3.00	0.5
34-DUM12C	3/4"	1/2"	1.63	3.00	0.5

SPECIFICATIONS

The dielectric union shall be rated for 250 psi (ANSI B 16.39). Flanged fittings shall be rated for 175 psi (ANSI B16.42 or B 16.24). The body and nut shall be steel with galvanized coat, the insulator shall be nylon, the tailpiece shall be brass and the gaskets shall be EPDM (standard) or viton (high temp). The dielectric fitting shall be a WILKINS Model DU, DUC or DUM.

DOCUMENT NO.	REV.
DU-C,M,BI	7/99