

### FEATURES

Sizes: ☐ 4" ☐ 6"

Maximum working water pressure

175 PSI

Maximum working water temperature

140°F

MJS-Mechanical Joint by Flange

AWWA C153-88

FLS- Flange by Flange

ANSI B16.1

Class 125

### ACCESSORIES

- ☐ Flange by groove adapter (FLA)
- ☐ Bolt Kit (BK)
- ☐ Strut Spacer (SS)

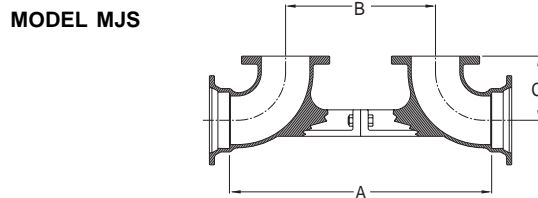
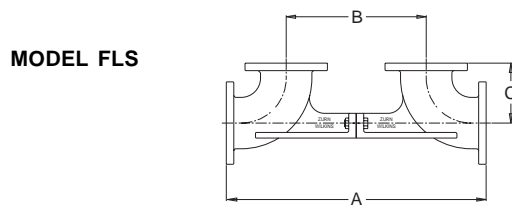

### DIMENSIONS & WEIGHTS (do not include pkg.)

MODEL	DIMENSIONS inches (approximate)					WEIGHT (lbs.)
	DESCRIPTION	FOR MODEL	A	B	C	
4-FLS	valve setter	4" ALL	31 5/16	18 5/16	6 1/2	82
4-MJS	valve setter	4" ALL	29 5/16	18 5/16	6 1/2	90
4-SS	strut spacer	4" 350/375	32 7/8	N/A	N/A	26
6-FLS	valve setter	6" ALL	34 11/16	18 11/16	8	166
6-MJS	valve setter	6" ALL	32 11/16	18 11/16	8	160
6-SS	strut spacer	6" 350	42 1/8	N/A	N/A	35

### SPECIFICATIONS

The mechanical joint by flange valve setter shall meet AWWA C153-88 and the flange by flange valve setter shall meet ANSI B16.1. The assembly shall be FDA Approved fusion epoxy coated ductile iron (ASTM A 536 Grade 4). The setter shall be a Wilkins Model FLS or MJS. The setter strut spacer shall be a WILKINS Model SS.

### APPLICATION

Designed to ease the installation of the N-shape or in-line Wilkins Model 350, 450, 375 and 475 series Backflow Prevention Assemblies. Ideal for retrofitting existing installations, or where space is limited. The integral thrust support between the elbows eliminates the need for additional thrust blocking. Optional strut spacer allows for use of setters with in-line devices.

### MATERIALS

Setter body

Ductile Iron ASTM A 536 Grade 4

Coatings

FDA Approved fusion epoxy finish

Fasteners

Plated steel

Spacer

Epoxy coated steel

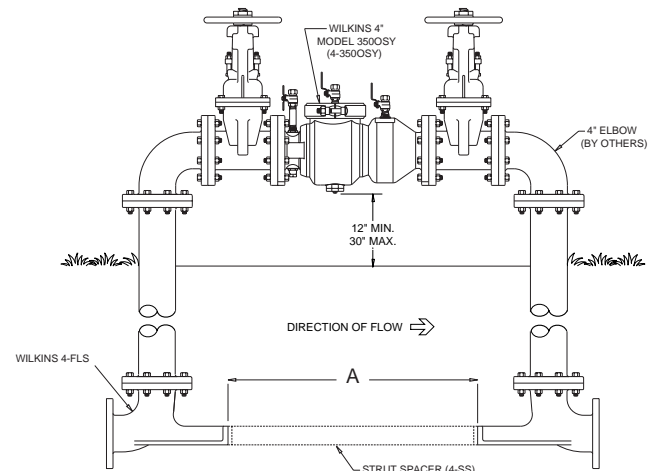

**MODEL 350 UNDERGROUND INSTALLATION**  
(MODEL FLS WITH STRUT SPACER)

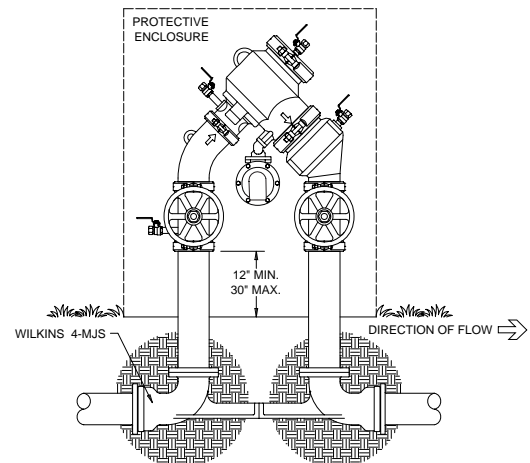

**MODEL 475 OPTIONAL INSTALLATION**  
(MODEL MJS)

DOCUMENT NO. <b>BF-BFSPACER</b>	REV. <b>10/99</b>
------------------------------------	----------------------