

Model 975XLFDC

Reduced Pressure Principle Assembly
with Fire Hydrant Connection

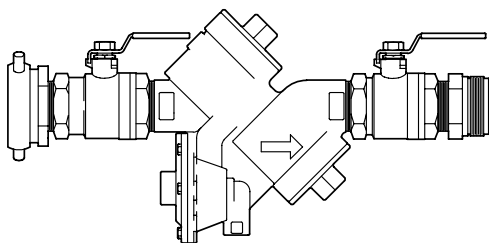

FEATURES

Sizes: ☐ 2"

Maximum working water pressure	175 PSI
Maximum working water temperature	180°F
Hydrostatic test pressure	350 PSI
Ball valves connections Threaded	ANSI B1.20.1
Fire Dept. connections (2½") Threaded	NSFHT

OPTIONS

(Suffixes can be combined)

☐ - with full port QT ball valves (standard)

APPLICATION

Designed for direct connection to fire hydrant on temporary construction water lines to protect against both backsiphonage and backpressure of contaminated water into the potable water supply. NSFHT adapters allow for connection to 2½" fire hydrant (inlet) and 2 ½" fire hose (outlet). Assembly shall provide protection where a potential health hazard exists.

STANDARDS COMPLIANCE

(applies to Model 975XL)

- ☐ ASSE® Listed 1013
- ☐ IAPMO® Listed
- ☐ UL® Classified (less shut-off valves or with OS&Y valves)
- ☐ C-UL® Classified
- ☐ CSA® Certified
- ☐ AWWA Compliant
- ☐ Approved by the Foundation for Cross Connection Control and Hydraulic Research at the University of Southern California
- ☐ City of Los Angeles Approved

MATERIALS

Main valve body	Cast Bronze ASTM B 584
Access covers	Cast Bronze ASTM B 584
Fasteners	Stainless Steel, 300 Series
Elastomers	Silicone (FDA approved)
	Buna Nitrile (FDA approved)
Polymers	Noryl™, NSF Listed
Springs	Stainless steel, 300 series
Connections	Cast Bronze ASTM B 584

ACCESSORIES

- ☐ Air gap
- ☐ Repair kit (rubber only)

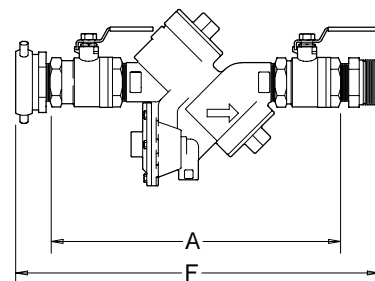
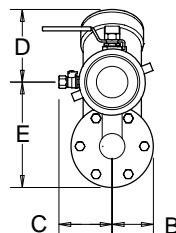

DIMENSIONS & WEIGHTS (do not include pkg.)

SIZE	DIMENSIONS (INCHES)						WEIGHT (LBS)
	A	B	C	D	E	F	WITH BALL VALVES
2"	18.50	2.70	3.50	5.00	6.70	22.25	37.0

FLOW CHARACTERISTICS

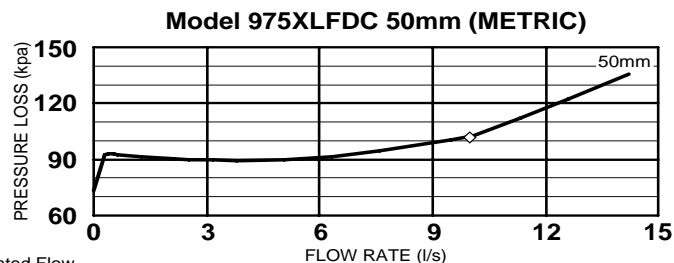
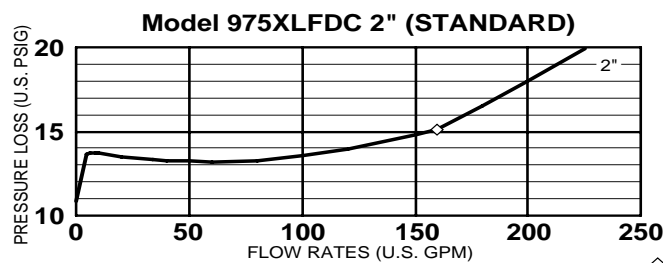

◇ Rated Flow
(Established by approval agencies)

TYPICAL INSTALLATION

Local codes shall govern installation requirements. To be installed in accordance with the manufacturer's instructions and the latest edition of the Uniform Plumbing Code. Unless otherwise specified, the assembly shall be mounted at a minimum of 12" (305mm) and a maximum of 30" (762mm) above adequate drains with sufficient side clearance for testing and maintenance. The installation shall be made so that no part of the unit can be submerged.

Capacity thru Schedule 40 Pipe

Pipe size	5 ft/sec	7.5 ft/sec	10 ft/sec	15 ft/sec
1/8"	1	1	2	3
1/4"	2	2	3	5
3/8"	3	4	6	9
1/2"	5	7	9	14
3/4"	8	12	17	25
1"	13	20	27	40
1 1/4"	23	35	47	70
1 1/2"	32	48	63	95
2"	52	78	105	167

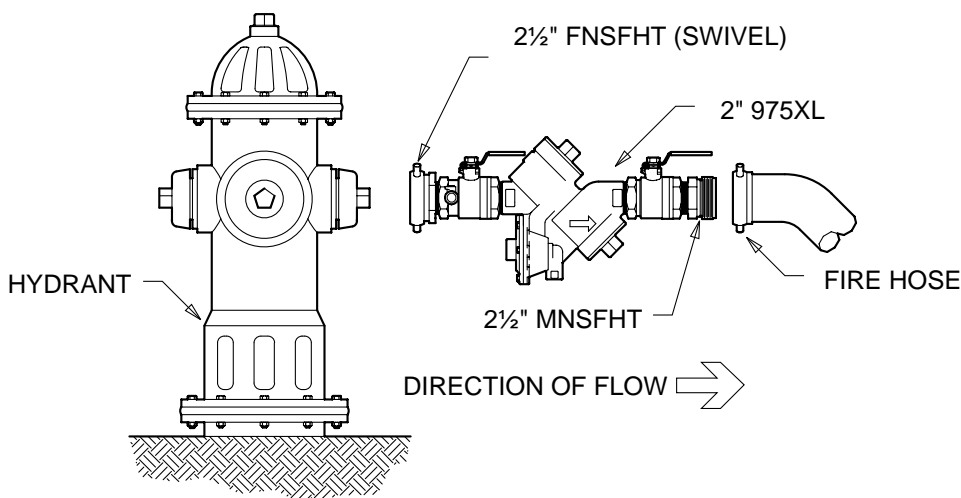

TYPICAL INSTALLATION

SPECIFICATIONS

The reduced pressure principle backflow preventer shall be ASSE® Listed 1013, rated to 180°F and supplied with full port ball valves. The inlet connection shall be a 2½" female NST swivel and the outlet connection shall be a 2½" male NST coupling. The main body and access covers shall be bronze (ASTM B 584), the seat ring and all internal polymers shall be NSF® Listed Noryl™ and the seat disc elastomers shall be silicone. The first and second checks shall be accessible for maintenance without removing the relief valve or the entire device from the line. The reduced pressure principle backflow preventer shall be a WILKINS Model 975XLDC.