

Model 910

Single Check Valve Assembly

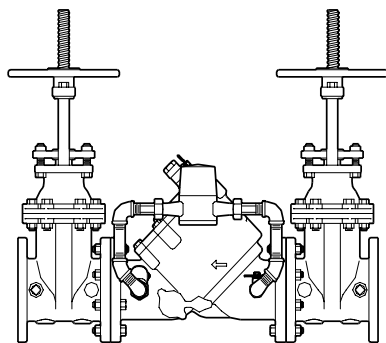

SHOWN AS MODEL 910DA
WITH OPTIONAL METER BY-PASS

APPLICATION

Designed for installation on municipal, fire sprinkler lines to protect against both backsiphonage and backpressure of polluted water into the potable water line.

FEATURES

Sizes: ☐ 4" ☐ 6" ☐ 8" ☐ 10"

Maximum working water pressure 175 psi
Maximum working water temperature 140° F
End connections Flanged ANSI B16.2 Class 125

OPTIONS

(Suffixes can be combined)

- ☐ - with OS&Y gate valves (standard)
- ☐ L - less gate valves
- ☐ DA - with meter by-pass line

ACCESSORIES

- ☐ Repair kit (rubber only)

MATERIALS

Main valve body Cast Iron ASTM A126 Class B
Access covers Cast Iron ASTM A126 Class B
Coatings FDA Approved Epoxy finish
Internals Stainless Steel, 300 Series
Cast Bronze ASTM B 584
Elastomers EPDM (FDA approved)
Buna Nitrile (FDA approved)
Springs Stainless steel, 300 series

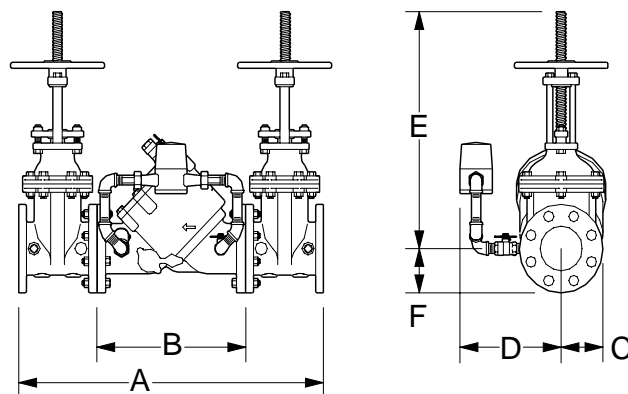

DIMENSIONS & WEIGHTS (do not include pkg.)

SIZE	DIMENSIONS (INCHES)							WEIGHT (LBS)	
	A	B WITHOUT GATE VALVES	C	D	E OS&Y GATE VALVES OPEN	E OS&Y GATE VALVES CLOSED	F	LESS GATE VALVES	WITH OS&Y GATE VALVES
4"	34.18	16.05	5.00	10.00	23.00	19.00	5.00	111.0	285.0
6"	41.50	20.37	6.00	14.00	31.00	25.00	6.00	258.0	526.0
8"	47.12	24.00	7.50	16.00	39.00	30.00	7.50	413.0	837.0
10"	55.12	29.00	9.00	18.00	46.00	36.00	9.00	650.0	1388.0

FLOW CHARACTERISTICS

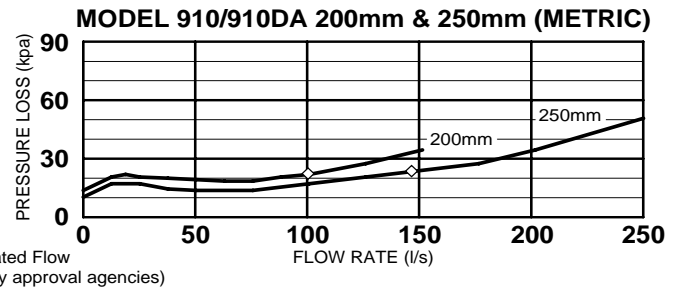
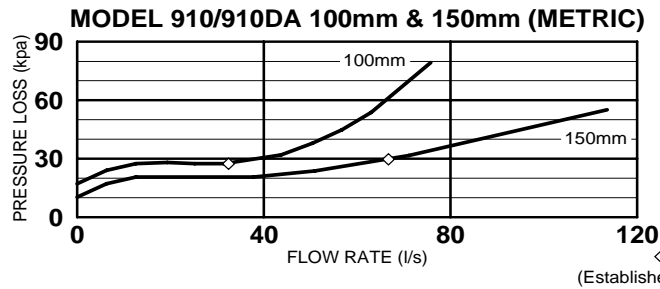
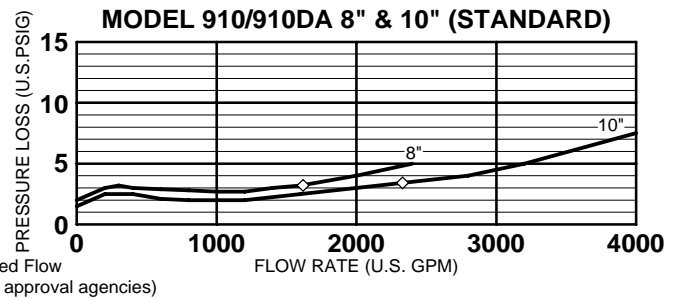
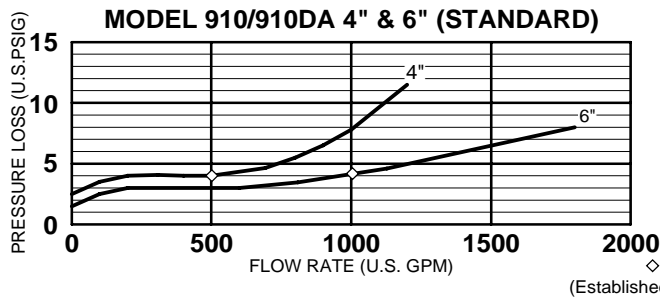

TYPICAL INSTALLATION

Local codes shall govern installation requirements. To be installed in accordance with the manufacturers' instructions and the latest edition of the Uniform Plumbing Code. Unless otherwise specified, assembly shall be mounted at a minimum of 12" (305mm) and a maximum of 30" (762mm) above adequate drain and sufficient side clearance for testing and maintenance. The installation shall be made so that no part of the unit can be submerged.

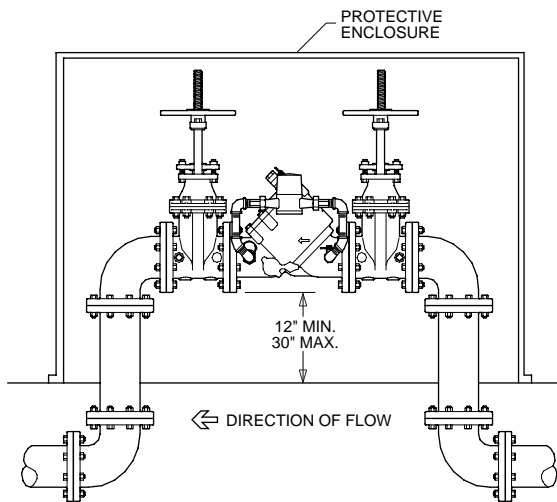

TYPICAL OUTDOOR INSTALLATION

Capacity thru Schedule 40 Pipe (GPM)				
Pipe size	5 ft/sec	7.5 ft/sec	10 ft/sec	15 ft/sec
2 1/2"	75	112	149	224
3"	115	173	230	346
4"	198	298	397	595
6"	450	675	900	1351
8"	780	1169	1559	2339
10"	1229	1843	2458	3687

SPECIFICATIONS

The single check valve backflow preventer shall be for horizontal and vertical flow-up installations. The main body and access covers shall be cast iron (ASTM A 126), the seat ring and check valve poppet shall be cast brass (ASTM B 584) and the seat disc elastomers shall be EPDM (FDA approved). The check shall be accessible for maintenance without removing the entire device from the line. The single check valve backflow preventer shall be a WILKINS Model 910.