

SHOWER PAN DRAIN

821 series

SPECIFICATION

Sioux Chief 821 series shower pan drain shall be used where necessary in drainage systems. Drain shall have a beveled flashing base adapter for subfloor installation. Strainer shall meet all load and flow requirements. Clamping collar shall fasten to drain body with four screws that thread into brass inserts. Drain body shall have a 2" Sch. 40 hub connection which conforms to ASTM D2665 (PVC) or D2661 (ABS) and connect to DWV pipe via solvent weld joint.

MATERIALS

strainer: 430 stainless steel

head adapter: ABS

clamping collar: ABS

base adapter: ABS or PVC

STRAINER LOAD RATING

300 lbs. (18 gauge)

STRAINER FREE AREA

3.25 in²

STRAINER FLOW CAPACITY (1/4" STANDING WATER)

7.02 gpm

DIMENSIONS

A: top diameter	4 ³ / ₈ "
B: flange diameter	6 ⁵ / ₈ "
C: adjustable height	3 ⁵ / ₈ "–5 ⁵ / ₈ "
D: drain body height	2 ⁵ / ₈ "
E: top housing thread	2" thread
F: connection	2" Sch. 40 hub

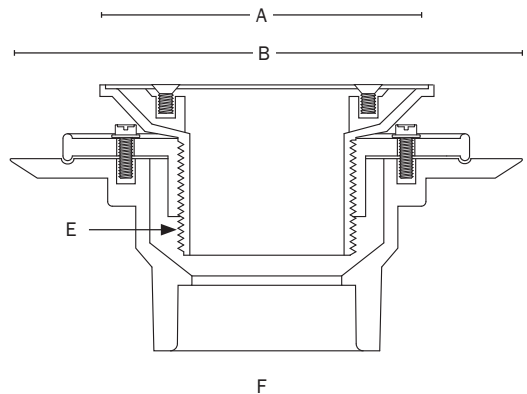

821-200P

Create Item Number

821- A B C D

e.g. 821-200P = PVC shower pan drain with stainless steel, screw-on strainer (into brass inserts) inside plastic rim head

A STRAINER TYPE
☐ 2 screw-on
☐ 27 snap-in

B BRASS INSERTS FOR STRAINER SCREWS
 (skip if using snap-in strainer)
☐ 0 brass inserts
 (no inserts are standard unless otherwise specified)

C HEAD ADAPTER
☐ 80 full metal top: no plastic rim
☐ 0 plastic rim top: thin plastic rim

D CONNECTION TYPE
☐ P PVC hub connection
☐ A ABS hub connection