

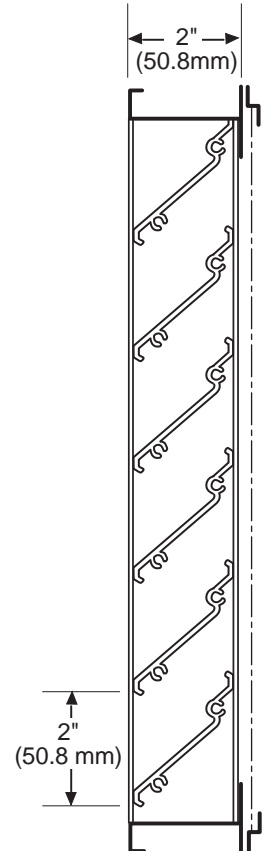

*MODEL XAZ-2
EXTRUDED STATIONARY LOUVER
STEP BLADE*

Standard Construction:

- Frame:** 2" x .063 (50.8 mm x 1.6 mm) extruded aluminum (6063-T5).
- Blades:** .063 (1.6 mm) extruded aluminum (6063-T5), approximately 2" (50.8 mm) on centers.
- Blade Angle:** 45°
- Screen:** Bird screen - 3/4" x .050 (19 mm x 12.7 mm) flattened expanded aluminum in a removable frame on interior of louver.
- Finish:** Mill aluminum.
- Minimum Size:** 6"w x 6"h (152 mm x 152 mm)
- Options:**
 - Screens:** Insect screen - 18 x 16 mesh aluminum
1/2" x .063 (12.7 mm x 1.6 mm) aluminum
Other - _____
 - Finish:** Prime Coat
Baked Enamel
Clear Anodize - 204-R1 and 215-R1
Integral Color Anodize
Kynar 500 Enamel
Other - _____
- Sill Extensions:**
 - Flange:** 1" (25.4 mm) (front or rear)
- Notes:** Louvers fabricated 1/4" (6.4 mm) under opening size unless otherwise noted.



Channel Frame

XAZ-2 - 02-05

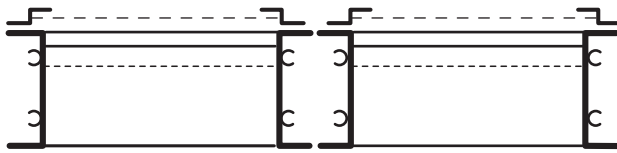

Jamb

Visible Mullion

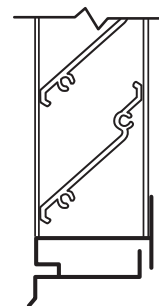

Sill Extension

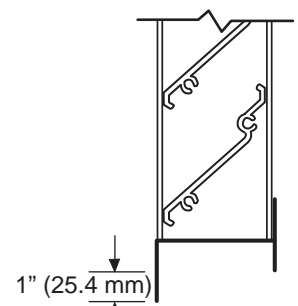

1" (25.4mm)

Flange Frame

Specifications are correct at time of printing. However, as part of our 'continuous improvement program,' we reserve the right to make further improvements without notice.
© JULY, 2000 NCA Manufacturing

Project: _____ Contractor: _____
 Location: _____ Address: _____
 Architect: _____ P.O. Number: _____
 Engineer: _____ Date: _____