



MODEL XAJ-4-375
EXTRUDED STATIONARY LOUVER
STRAIGHT BLADE

Standard Construction:

Frame: 4" x .081 (101 mm x 2.1 mm) extruded aluminum (6063-T5).

Blades: .081 (2.1 mm) extruded aluminum (6063-T5),
 approximately 3" (76 mm) on centers.

Blade Angle: 37.5°

Screen: Bird screen - 3/4" x .050 (19 mm x 12.7 mm)
 flattened expanded aluminum in a removable
 frame on interior of louver.

Finish: Mill aluminum.

Minimum Size: 8"w x 10"h (203 mm x 254 mm)

Options:

Screens: Insect screen - 18 x 16 mesh aluminum

Other - _____

Finish: Prime Coat

Baked Enamel

Clear Anodize - 204-R1 and 215-R1

Integral Color Anodize

Kynar 500 Enamel

Other - _____

Sill Extensions:

Flange: 1-1/2" (38 mm) (front or rear)

Frame: .125 (3.2 mm) Extruded Aluminum

Notes: Louvers fabricated 1/4" (6.4 mm) under
 opening size unless otherwise noted.

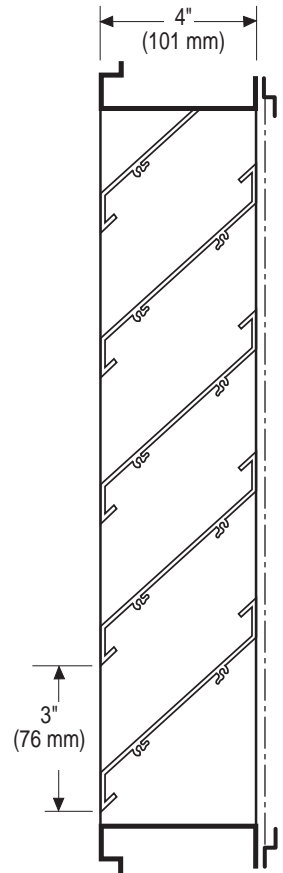

Channel Frame

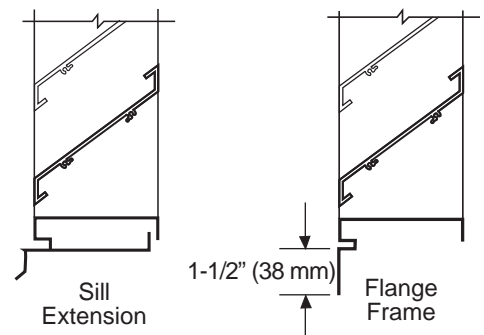
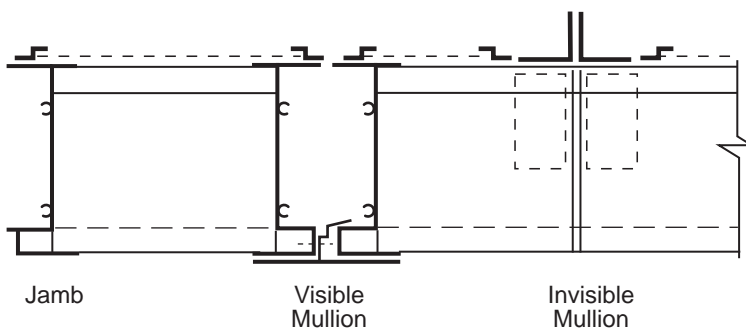

XAJ-4-375 - 02-05

Specifications are correct at time of printing. However, as part of our 'continuous improvement program,' we reserve the right to make further improvements without notice.

© JULY, 2000 NCA Manufacturing

Project:

Contractor:

Location:

Address:

Architect:

P.O. Number:

Engineer:

Date: