



*MODEL MP-2920 & MP-2923*  
*ELECTRIC OPERATOR*  
*120 & 24 VOLT*

© 1999 NCA Manufacturing

**Specifications:**

	<b>MP-2920</b>	<b>MP-2923</b>
<b>Electrical:</b>	120 volts A.C., 60 Hz, 1 phase	24 volts, A.C., 60 Hz, 1 phase
<b>Running:</b>	.36 Amperes	1.5 Amperes
<b>Holding:</b>	.38 Amperes	1.6 Amperes
<b>Motor:</b>	Shaded pole, 2 position, spring return	Shaded pole, 2 position, spring return
<b>Torque:</b>	<b>Stall:</b> 57 in. lbs. <b>Restart:</b> 32 in. lbs.	43 in. lbs. 30 in. lbs.
<b>Rotation:</b>	2.0 RPM, CCW	2.0 RPM, CCW
<b>Construction:</b>		
<b>Housing:</b>	Die cast aluminum	
<b>Bearings:</b>	Bronze, Semi-oiless, maintenance free.	
<b>Gears:</b>	Precision machine cut.	
<b>Normal Application:</b>	Actuator is for two position, spring return application. With power on, actuator runs to open (or close) damper, with power off, external spring returns damper to opposite position.	

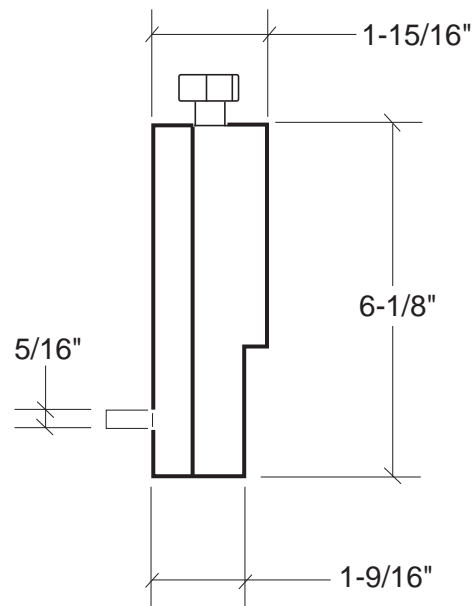
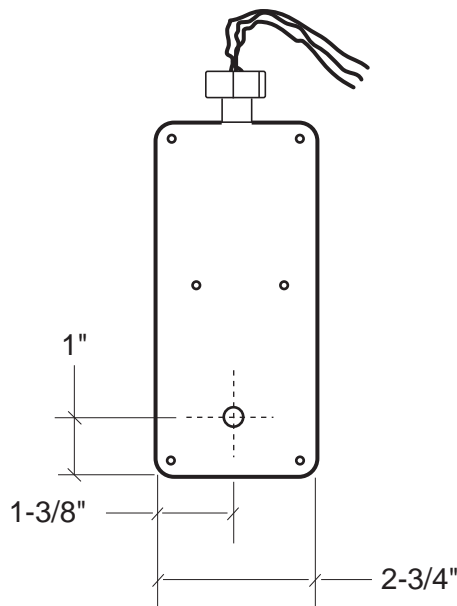

**Wiring Diagram**

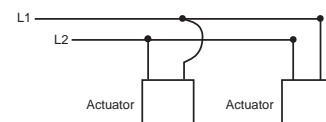
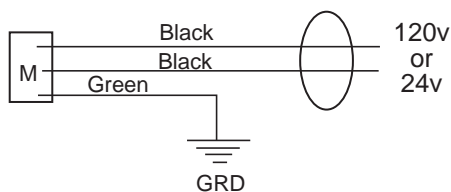

**Multiple Actuator  
Field Wiring / Pneumatic Piping**

Specifications are correct at time of printing. However, as part of our 'continuous improvement program,' we reserve the right to make further improvements without notice.