

# 4RC and 4RCX (Explosion-Proof)

4" Non-Clog Wastewater Pumps  
Standard (4RC) and Explosion-Proof (4RCX) Construction



**T**HE 4RC AND 4RCX (EXPLOSION-PROOF) SUBMERSIBLE WASTEWATER PUMPS ARE THE RIGHT CHOICE WHEN DIFFICULT TO PUMP FIBEROUS OR STRINGY SOLIDS ARE TO BE EXPECTED. The 4RC/4RCX series provides smooth, vibration-free operation when operating at heads higher than peak efficiency. The pump is for use in municipal lift stations, treatment plants and industrial waste applications. Myers offers a complete line of wastewater pumps, lift-out rail assemblies, controls and accessories to meet your needs. Call your Myers distributor, or the Myers Ohio sales office at 419/289-1144 for more details.

## ADVANTAGES BY DESIGN

**PASSES STRINGY TRASH, FIBEROUS WASTES, SLURRIES, AND OTHER DIFFICULT TO PUMP SOLIDS THAT STANDARD ENCLOSED OR SEMI-OPEN IMPELLERS CANNOT.**

- Recessed impeller design has completely open passage in volute.
- Pumping action is by vortex; solids can't get caught in impeller volute.
- Operates without vibration or cavitation over entire performance curve. Operates near shutoff without harming pump.

## DURABLE MOTOR WILL DELIVER MANY YEARS OF RELIABLE SERVICE.

- Recessed impeller greatly increases bearing life by reducing radial load.
- Oil-filled motor for maximum heat dissipation and constant bearing lubrication.
- Heat sensor thermostats imbedded in windings protect motor from over heat conditions.
- Seal leak probes warn of moisture entry; helps prevent costly motor burn-out

**AVAILABLE WITH OPTIONAL F.M. APPROVAL FOR USE IN CLASS 1, GROUPS C AND D HAZARDOUS LOCATIONS (4RCX ONLY).**

## PRODUCT CAPABILITIES

Capacities To	750 gpm	47.3 l/s
Heads To	265 ft.	80.8 m
Solids Handling	3 in.	76 mm
Liquids Handling	raw unscreened sewage, fibrous wastewater, effluent, storm water	
Intermittent Liquid Temp.	up to 140°F	up to 60°C
Winding Insulation Temp. (Class F)	311°F	155°C
Available Motors	3450 rpm 20-60 hp, 230/460/575 volts, 3 phase, 60 Hz	
Std. Third Party Approvals	CSA	
Optional Approvals	FM, Class 1, Div. 1, Groups C & D (4RCX only)	
Acceptable pH Range	6 - 9	
Specific Gravity	.9 - 1.1	
Viscosity	28 - 35 SSU	
Discharge, Horizontal Flanged Centerline	4 in. 125 lb. ANSI	101.6 mm

NOTE: Consult factory for applications outside of these recommendations.

Construction Materials	
Motor Housing, Seal Housing, Cord Cap and Volute Case	cast iron, Class 30 ASTM A48
Recessed, Impeller	ductile iron, Class 65 ASTM A536
Power and Control Cord	25 ft. SOW/SOW-A
Mechanical Seals	double tandem, type 21
Standard	carbon and ceramic
Optional	lower tungsten, carbide
Pump, Motor Shaft	416 SST
Fasteners	300 Series SST

**WHERE INNOVATION MEETS TRADITION**

# 4RC and 4RCX (Explosion-Proof)

4" Non-Clog Wastewater Pumps  
Standard (4RC) and Explosion-Proof (4RCX) Construction

## POWER & CONTROL CORDS

SOW-A, FM and CSA approved oil-resistant cable.

## CABLE ENTRY SYSTEM

Provides triple seal protection. Cable jacket sealed by compression grommet. Individual wires sealed by epoxy potting. Terminal board separates motor chamber from cord cap.

## HEAT SENSOR

Protects motor from burnout due to excessive heat from any overload condition. Automatically resets when motor has cooled.

## MOTOR STATOR

Heat shrunk into housing for perfect alignment and best heat transfer. Oil-filled motor conducts heat and lubricates bearings.

## BALL BEARINGS

Upper and lower ball bearings support shaft and rotor and take axial and radial loads.

## SHAFT SEALS

Double tandem mechanical shaft seals protect motor. Oil-filled seal chamber provides continuous lubrication.

## SLEEVE BEARING

Takes radial shock load; provides flame path.

## SEAL LEAK PROBES

Detect water in seal housing. Activate warning light in control panel.

## HEAVY 416 SST SHAFT

Corrosion resistant.

## VOLUTE CASE

Handles 3" solids. Completely open from inlet to discharge. 4" ANSI 125 lb. flange.

## RECESSED IMPELLER

Handles stringy trash and slurries without clogging or binding. Pump out vanes help keep trash from seal; reduces pressure at seal faces.

## DIMENSIONS

[ ] Dimensions in mm

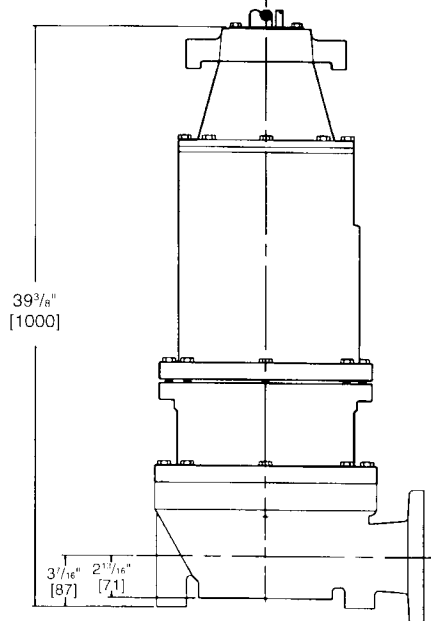
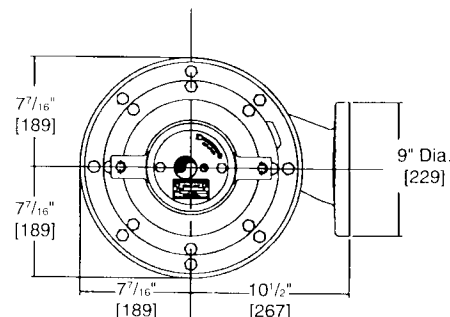

## PERFORMANCE CURVE

