

Butterball VALVE

BB2 SERIES

1/4"-2" 175 PSI (1207kPa)

THREADED END ONLY

WW-V-1967

THREADED END - FIG# BB2-100

SOLDER END - FIG# BB2-350



RATINGS

- 175 psig WOG
 - CSA (AGA/CGA) & UL Ratings^{(1)(*)}
 - Vacuum to 29"
- ¹(Except 1/4" & 3/8" Threaded end)

FEATURES

- Full Port Design
- Full Flow, High Cv
- One Piece Bronze Body*
- Stainless Steel stem and disc
- Viton Seal
- Excellent throttling characteristics
- Requires no system pressure to seal
- 30°F to 275°F Temperature Range

APPLICATIONS

- Natural Gas Shut-off*
(1/2" psi and 5 psi)
- LP Gas Shut-off*
- Gas and Air Systems
- Fuel Oil (Types 1-6)*
- Oil Systems*
- Liquid Service including water⁽²⁾
- Throttling, Balancing & Shut-off
- Vacuum Service

* Applies to BB2-100 Series Threaded End only

⁽²⁾Do not use on hot water over 120° F

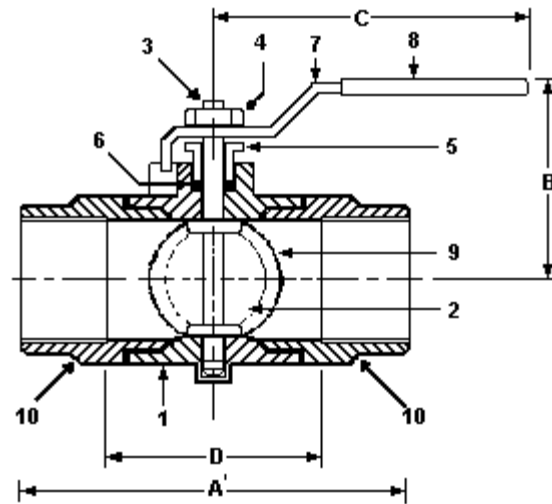
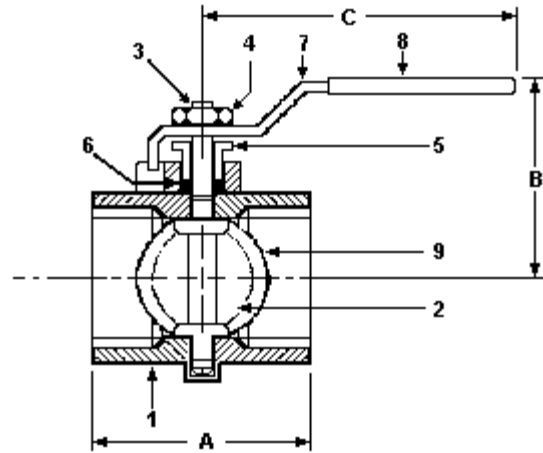

MATERIALS

ITEM	PART	MATERIALS	ASTM SPEC.
1	Body	Bronze	ASTM-B584
2	Disk	Stainless Steel	Type 304
3	Stem	Stainless Steel	Type 303
4	Hex Nut	Stainless Steel	Type 302
5	Gland	Rod Bronze	CA-360
6	Packing	Nylon	
7	Handle	Steel w/ Zinc Plating	
8	Flat Grip	Vinyl	
9	Disc Seat	Viton	
10	Tailpiece	Bronze	ASTM-B584

DIMENSIONS

	UNITS	1/4"	3/8"	1/2"	3/4"	1"	1-1/4"	1-1/2"	2"
A	INCHES	2.25	2.38	1.88	2.00	2.13	2.63	2.88	3.25
	mm	57.2	60.3	47.6	50.8	54.0	66.7	73.0	82.6
A ¹	INCHES	NA	2.38	2.50	3.13	3.63	4.38	4.88	5.63
	mm		60.3	63.5	79.4	92.1	111.1	123.8	142.9
B	INCHES	1.50	1.50	1.50	1.56	1.75	2.19	2.31	3.63
	mm	38.1	38.1	38.1	39.6	44.5	55.63	58.7	92.2
C	INCHES	3.50	3.50	3.50	3.50	3.50	5.00	5.00	5.00
	mm	88.9	88.9	88.9	88.9	88.9	127	127	127
D	INCHES	NA	1.63	1.50	1.63	1.81	2.44	2.69	2.94
	mm		41.4	38.1	41.4	46.0	62.0	68.3	74.7
Cv		10	10	13	25	43	85	112	180
Torque	in/lb	18	18	18	22	35	50	70	120
Weight	BB2-100	0.6	0.6	0.5	0.7	0.8	1.0	1.5	3.0
	(lbs) BB2-350	NA	0.5	0.5	0.6	1.0	1.6	2.0	3.7

The information presented on this sheet is correct at the time of publication. Milwaukee Valve reserves the right to change design, and/or material specifications without notice. For the most current information access www.milwaukeevalve.com.

MILWAUKEE VALVE

