

BA-350/350S

1/2"-2"

**BRONZE BALL VALVE
THREE-PIECE, FULL-PORT
600 WOG / 150 SWP *
SOLDERED ENDS**



FED. SPEC. WW-V-35C II, BZ, 1
MSS SP-110

MATERIALS LIST

ITEM	PART	MODEL	MATERIALS	ASTM SPEC.
1	Body	350 & 350S	Bronze	B584
2	End Cap	350 & 350S	Bronze	B584
3	Stem	350	Brass	B16
		350S	316 Stainless Steel	B276
4	Packing Nut	350 & 350S	Brass	B16
5	Packing	350 & 350S	PTFE	
6	Thrust Washer	350 & 350S	RPTFE (25% Glass Reinforced)	
7	Ball	350	CP Brass	B16
		350S	316 Stainless Steel	B276
8	Seats	350 & 350S	RPTFE (15% Glass Reinforced)	
9	Handle	350 & 350S	Steel w/ Zinc Plating	B633
10	Handle Nut	350 & 350S	Steel w/ Zinc Plating	B633
11	Handle Grip	350 & 350S	Vinyl	
12	Body Bolts	350 & 350S	Steel (Gr 8) w/ Zinc Plating	B633
13	Body Nuts	350 & 350S	Steel (Gr 8) w/ Zinc Plating	B633

* Milwaukee Valve Company recommends the use of Stainless Steel ball and stem for steam applications. Please consult factory for more information.

BA350mls.xls

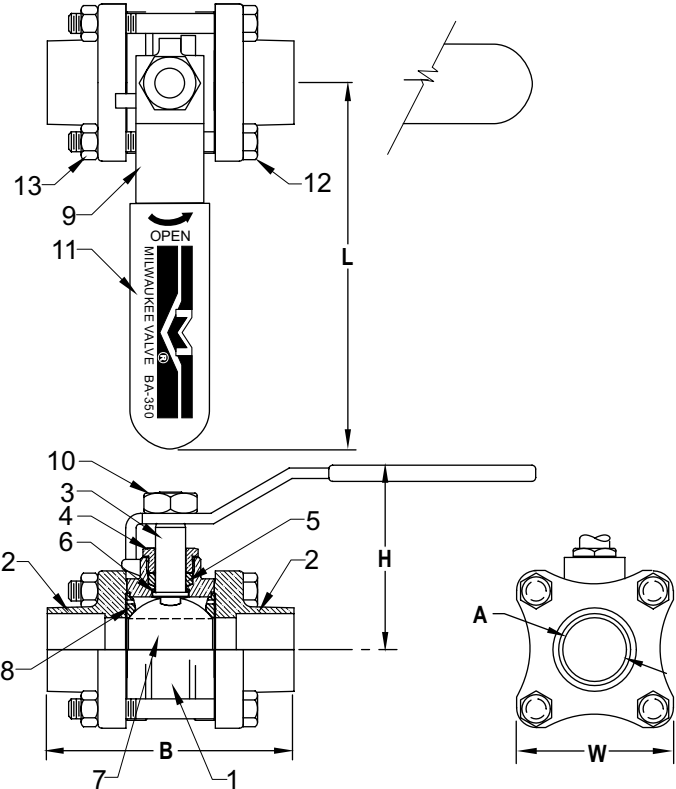

PRESSURE and TEMPERATURE CHART

VALVES RATED FOR VACUUM SERVICE TO 29 INCHES Hg.

— Seat Material Rating
- - - Solder Joints per ANSI B16.18

1/2" Through 1-1/2" Sizes

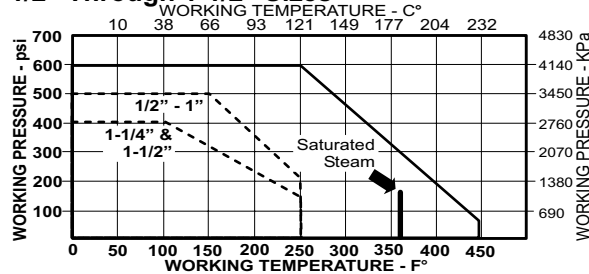

2" Size Only

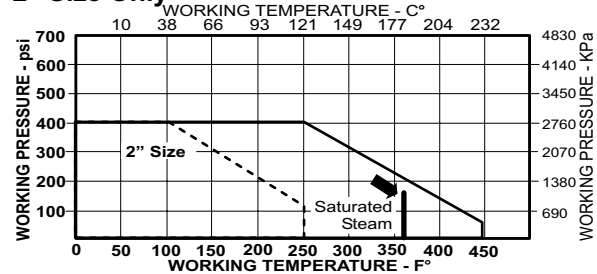

DIMENSIONS

	UNITS	1/2"	3/4"	1"	1-1/4"	1-1/2"	2"
A (DIA)	INCHES	DN15	DN20	DN25	DN32	DN40	DN50
	mm	0.5	0.75	1	1.25	1.5	2
B	INCHES	2.8	3.44	3.87	4.75	5.25	6.1
	mm	71	87	98	121	133	155
H	INCHES	1.95	2.26	2.44	2.8	3.12	3.58
	mm	50	57	62	71	79	91
L	INCHES	3.88	4.75	4.75	6.5	7.38	7.38
	mm	99	121	121	165	187	187
W	INCHES	1.91	2.19	2.46	2.98	2.98	4
	mm	49	56	62	76	76	102
Cv		17	31	60	110	185	360

NOTE: DN (Diameter Nominal)=Metric equivalent size.

BA350dims.cdr

The information presented on this sheet is correct at the time of publication. Milwaukee Valve reserves the right to change design, and/or material specifications without notice. For the most current information access www.milwaukeevalve.com.

