

# GLOBE 1502

## BRONZE

125 lb. SWP-200 lb. WOG† • Plumbing and Heating  
Bronze Disc • Threaded Bonnet • Sweat Ends

3/8" and 1/2" sizes have the disc integral with the stem and have no disc ring.

Dimensions shown are for solder ends. Brazed end preparation also available.

### SPECIFICATIONS

1502	Conforms to: MSS SP-80. Type 1, Class 125, Soldered Ends.
------	---

### MATERIAL LIST

NO.	PART	MATERIAL	SPECIFICATION
1	Body	Bronze	ASTM B 62
2	Bonnet	Bronze	ASTM B 62
3	Disc	Bronze	ASTM B 62
4	Stem	Bronze	ASTM B 62
5	Disc Ring	Bronze	ASTM B 16 3/4" to 2" Incl.
6	Packing	Non-Asbestos	Commercial
7	Packing Nut	Bronze	Commercial
8	Handwheel	Mall. Iron	Commercial
9	Identification Plate	Aluminum	Commercial
10	Handwheel Nut	Bronze	Commercial

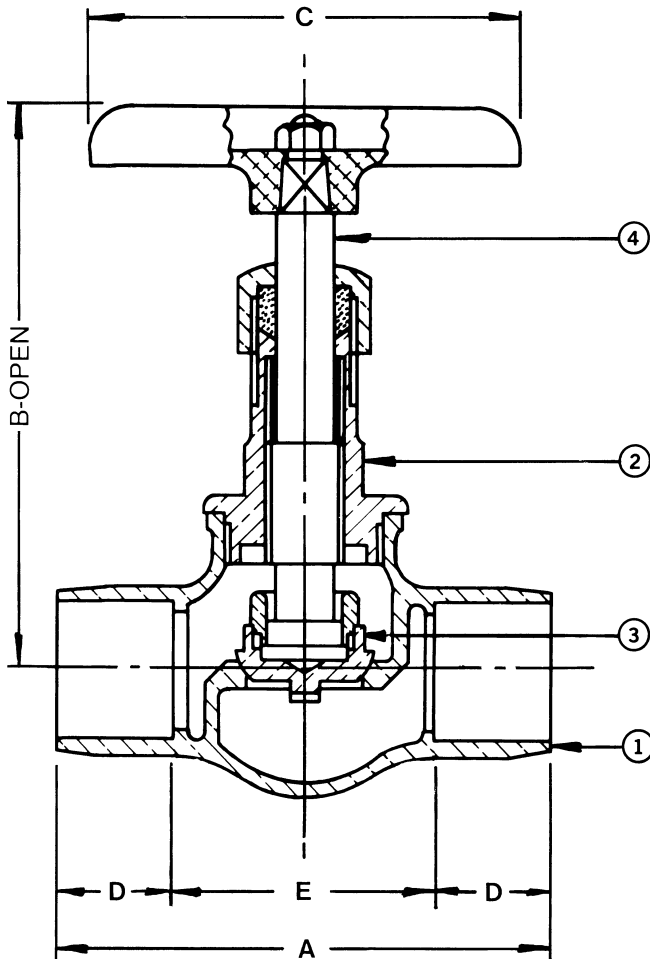

### DIMENSIONS - INCHES / MILLIMETERS

Units	Size	A	B	C	D	E
Inches	3/8	2	3 3/16	2	3/8	1 1/4
MM	9.53	50.80	80.98	50.80	9.53	31.75
Inches	1/2	2 7/16	3 3/4	2 1/4	1/2	1 7/16
MM	12.70	61.91	95.25	57.15	12.70	36.53
Inches	3/4	3 3/16	4	2 1/2	3/4	1 11/16
MM	19.05	80.98	101.60	63.50	19.05	42.88
Inches	1	3 11/16	4 3/8	2 3/4	29/32	1 7/8
MM	25.40	93.66	111.13	69.85	23.01	47.63
Inches	1 1/4	4 3/16	5 1/8	3 1/8	31/32	2 1/4
MM	31.75	106.38	130.18	79.38	24.61	57.15
Inches	1 1/2	4 3/4	5 5/8	3 1/2	1 3/32	2 9/16
MM	38.10	120.65	142.88	88.90	27.79	65.10
Inches	2	5 15/16	6 11/16	4	1 11/32	3 1/4
MM	50.80	150.83	169.88	101.60	34.13	82.55

† Non-Shock

**INNOVATION** IN EVERY VALVE



**MILWAUKEE VALVE**

The information presented on this sheet is correct at the time of publication. Milwaukee Valve reserves the right to change design, and/or material specifications without notice. For the most current information access [www.milwaukeevalve.com](http://www.milwaukeevalve.com)

[www.milwaukeevalve.com](http://www.milwaukeevalve.com)