

Tag:
Series : **OAL**

METAL*LAIRE®
Submittal No: **OAL**

**Outside Air Louvers
Extruded Aluminum**

Model: **OAL-2C** Type C - Channel Frame - 2" Depth
 OAL-2F Type F - Flanged Frame - 2" Depth

Model: OAL-2C (Type C - Channel Frame - 2" Depth)

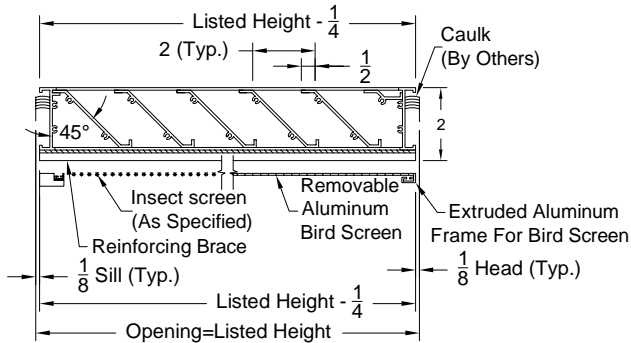

Model: OAL 2C (Face View)

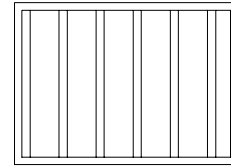

Model: OAL 2F (Face View)

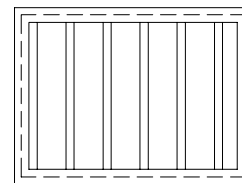

Model: OAL-2F (Type F - Flanged Frame - 2" Depth)

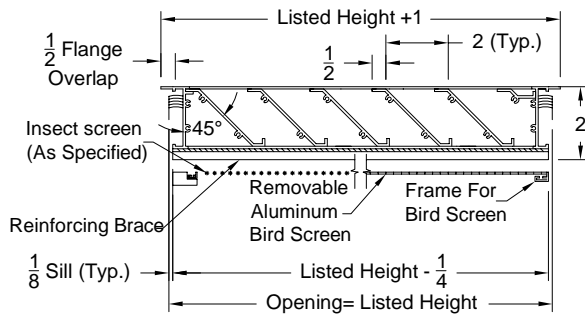

Model: OAL-2C

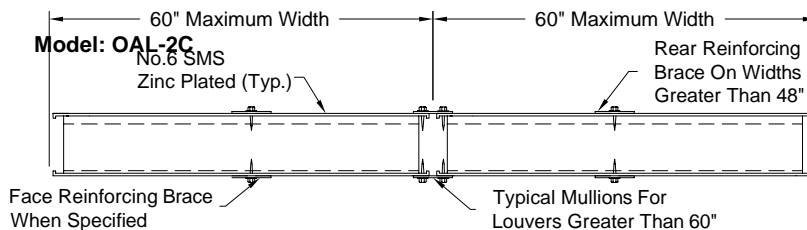

Model: OAL-2C (Side View)

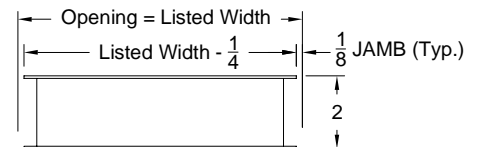

Model: OAL-2F

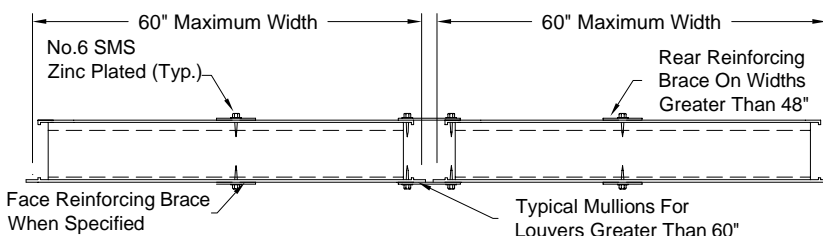

Model: OAL-2F (Side View)

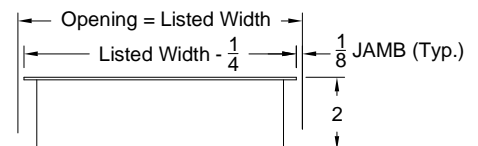

Dimensions are in inches

Tag:
Series : OAL

METAL*AIRE®
Submittal No: OAL

Outside Air Louvers Extruded Aluminum

Model: OAL-4 C Type C - Channel Frame - 4" Depth
OAL-4 F Type F - Flanged Frame - 4" Depth

Model: OAL 4 C (Type 4 C - Channel Frame - 4" Depth)

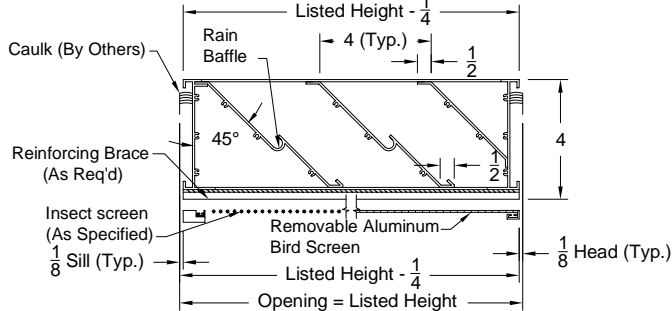

Model: OAL 4 C (Face View)

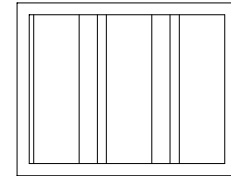

Model: OAL 4 F (Type 4 F - Flange Frame - 4" Depth)

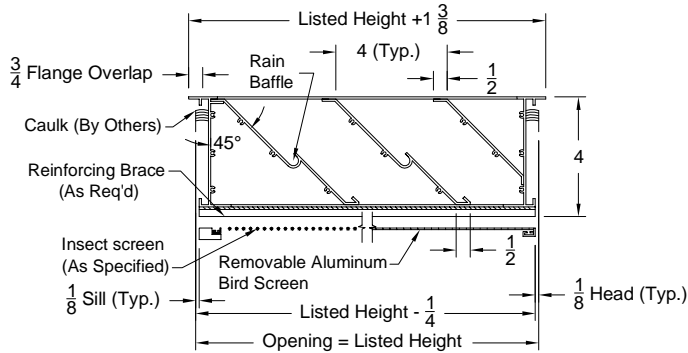

Model: OAL 4 F (Face View)

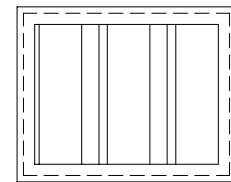

Model: OAL 4 C

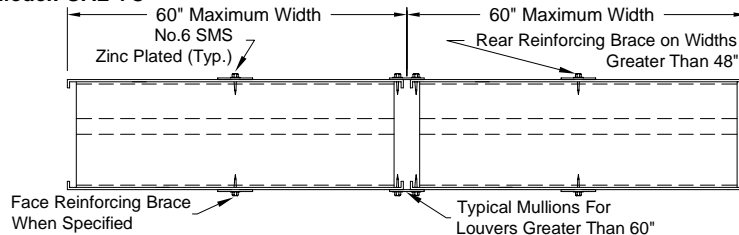

Model: OAL 4 C (Side View)

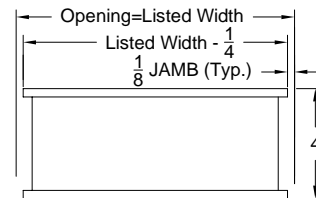

Model: OAL 4 F

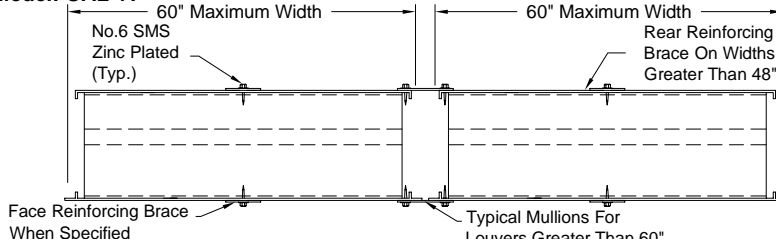

Model: OAL 4 F (Side View)

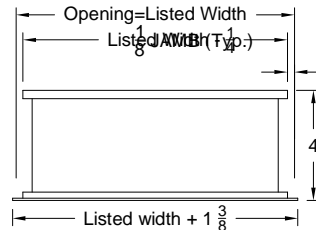

1. Available Finishes

Standard Finish:

☐ 24 Mill.

Optional Finish (extra charge):

☐ 01 White.

☐ 02 Aluminum.

☐ 04 Anodized.

☐ 05-07 Bronze Anodized.

2. Available Option

(Factory Mounted)

☐ I/S Insect Screen - #18 Aluminum Mesh

☐ B/S Bird Screen - Expanded Aluminum.

3. Construction Details

• Maximum 1-piece dimension of 72" x 120" or 120" x 72".

• Even / Odd Inch Sizes for widths.

• Height available only as listed.

Notes: (☐ check if provided)

Dimensions are in inches

Cad File Number: OAL-p2-87

Date: 03/25/2003

Submittal No. OAL

Page: 2 of 2