



## BRONZE GLOBE VALVE

I.P.S.



MODEL  
T-421

MATERIAL SPECIFICATION	
PART	MATERIAL
BODY	BRONZE
BONNET	BRONZE
STEM	FORGED BRASS
PACKING NUT	BRASS
DISC	BRASS
HAND WHEEL	ALUMINUM
WHEEL NUT	BRASS
GLAND	BRASS
GLAND PACKING	GRAPHITE/TEFLON*

**PRESSURE RATING**  
200 W.O.G. NON-SHOCK  
125 W.S.P.

\*DUPONT REG T.M.

**LEGEND MODEL T-421** bronze globe valves have a screwed bonnet, rising stem, integral seat and swivel disc for accurate throttling and flow control. The body and bonnet are constructed of heavy duty bronze. Recommended for heavy industrial use when the valve is to be operated frequently

### DIMENSIONS IN INCHES

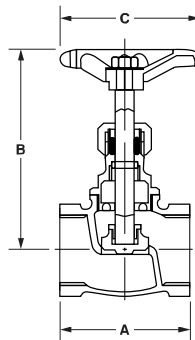

VALVE SIZE	A (IPS)	B	C
1/2"	1.96	2.81	1.97
3/4"	2.18	3.27	2.21
1"	2.56	3.90	2.36
1 1/4"	2.92	4.30	3.23
1 1/2"	3.29	4.94	3.34
2"	3.90	5.95	3.94

## BRASS SWING CHECK VALVE

I.P.S. AND CxC



MODEL  
T-451



MODEL  
S-451

MATERIAL SPECIFICATION	
PART	MATERIAL
CAP	BRASS
BODY	BRASS
DISC	BRASS
HINGE PIN	BRASS
SCREW	BRASS

**PRESSURE RATING**  
200 W.O.G. NON-SHOCK

**LEGEND MODELS T-451/S-451** check valves are constructed of heavy duty brass. They have a screwed cap, swing type disc and integral seat. They prevent backflow while offering full flow performance with a minimum of turbulence or pressure loss. Recommended for residential and commercial applications.

### DIMENSIONS IN INCHES

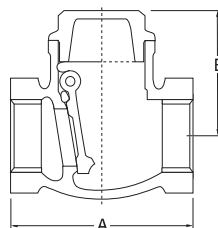

VALVE SIZE	A (IPS)	A (CxC)	B
3/8"	2.01		1.40
1/2"	2.01	2.44	1.34
3/4"	2.29	3.03	1.42
1"	2.48	3.74	1.54
1 1/4"	3.15	4.37	1.89
1 1/2"	3.47	5.12	2.17
2"	3.98	5.95	2.56
2 1/2"	5.16	6.90	2.96
3"	5.79	7.60	3.82
4"	6.86		3.94



## BRONZE Y-PATTERN CHECK VALVE

I.P.S. AND CxC



MODEL  
T-453



MODEL  
S-453

MATERIAL SPECIFICATION	
PART	MATERIAL
CAP	BRONZE
BODY	BRONZE
DISC	BRONZE
HINGE PIN	BRASS
SCREW	BRASS

**PRESSURE RATING**  
300 W.O.G. NON-SHOCK  
150 W.S.P.

**LEGEND MODELS T-453/S-453** y-pattern check valves are constructed of heavy duty bronze. They have a screwed cap, swing type disc and integral seat. The y-pattern design has excellent full flow characteristics and can be installed vertically or horizontally.

Recommended for preventing backflow in commercial and industrial applications.

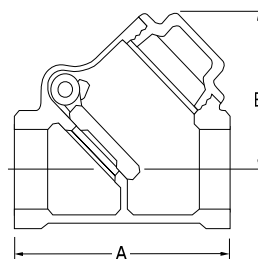

### DIMENSIONS IN INCHES

VALVE SIZE	A (IPS)	A (CxC)	B
1/2"	2.19	2.56	1.67
3/4"	2.76	3.44	2.01
1"	3.11	4.06	2.28
1 1/4"	3.74	4.69	2.69
1 1/2"	4.33	5.38	3.07
2"	5.08	6.69	3.78

## BRONZE IN-LINE CHECK VALVE

SPRING LOADED  
I.P.S. AND CxC



MODEL  
T-455



MODEL  
S-455

MATERIAL SPECIFICATION	
PART	MATERIAL
BODY	BRONZE
END ADAPTER	BRONZE
DISC	BUNA-N
DISC	1/2" - 1 1/4" FORGED BRASS
HOLDER	1 1/2" - 2" BRONZE
SPRING	PHOSPHOR BRONZE

**PRESSURE RATING**  
250 W.O.G.

**LEGEND MODELS T-455/S-455** spring loaded in-line check valves are constructed of heavy duty bronze. They are silent type and have Buna-N discs for quick, silent closing. They provide positive backflow prevention and minimized water hammer. They may be installed in any position. Recommended for preventing backflow in commercial and industrial applications.

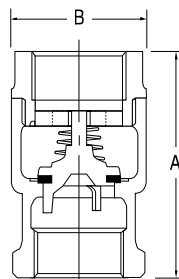

### DIMENSIONS IN INCHES

VALVE SIZE	A (IPS)	A (CxC)	B
1/2"	2.09	2.40	1.22
3/4"	2.32	2.80	1.50
1"	2.64	3.54	1.89
1 1/4"	3.07	3.86	2.16
1 1/2"	3.31	4.23	2.60
2"	3.78	5.08	3.14