

### Features

- Vitreous china
- Washout
- 3/4" top spud
- 0.5 gpf (1.89 lpf) to 1 gpf (3.78 lpf)
- 14" (35.6 cm) extended rim

### Codes/Standards Applicable

Specified model meets or exceeds the following:

- ASME A112.19.2
- IAPMO/UPC
- ICC/ANSI A117.1
- Energy Policy Act of 1992 (EPACT)
- CSA B45
- ADA when rim is mounted no higher than 17" (43.2 cm) from finished floor

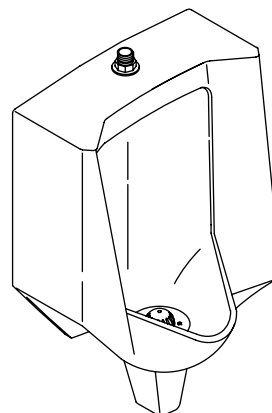

### Colors/Finishes

- 0: White
- Other: Refer to Price Book for additional colors/finishes

### Accessories:

- G: Brushed Chrome

### Specified Model

Model	Description	Colors/Finishes	
K-4960-ET	3/4" top spud urinal	<input type="checkbox"/> 0	<input type="checkbox"/> Other_____
<b>Optional Accessories</b>			
K-13686	Touchless battery-powered urinal flush valve, fixture mounted	<input type="checkbox"/> G	

### Product Specification

Washout urinal shall be made of vitreous china with a 3/4" top spud. Urinal shall have a 14" (35.6 cm) extended rim. Urinal shall include a removable beehive strainer, inlet and outlet spud, and hangers. Urinal shall use 0.5 gpf (1.89 lpf) to 1 gpf (3.78 lpf). Urinal shall be Kohler Model K-4960-ET-\_\_\_\_\_.

# BARDON™ SUPERIOR

## Technical Information

Urinal complies with ADA requirements when rim is mounted no higher than 17" (43.2 cm) from finished floor.	
ADA	
Fixture:	
Configuration	3/4" top spud urinal
Water per flush	0.5 gal (1.89 L) to 1 gal (3.78 L)*
Spud inlet size	3/4"
*Designed to flush with 0.5 gal (1.89 L) when installed with a 0.5 gal (1.89 L) flush valve.	
Included components:	
3/4" inlet spud	18376
2" outlet spud	18766
Strainer	85061
Hanger (2 required)	64512

## Installation Notes

Install this product according to the installation guide.

Refer to manufacturer's instructions and local codes for flush valve requirements.

\*Urinal complies with ADA requirements when rim is mounted no higher than 17" (43.2 cm) from finished floor.

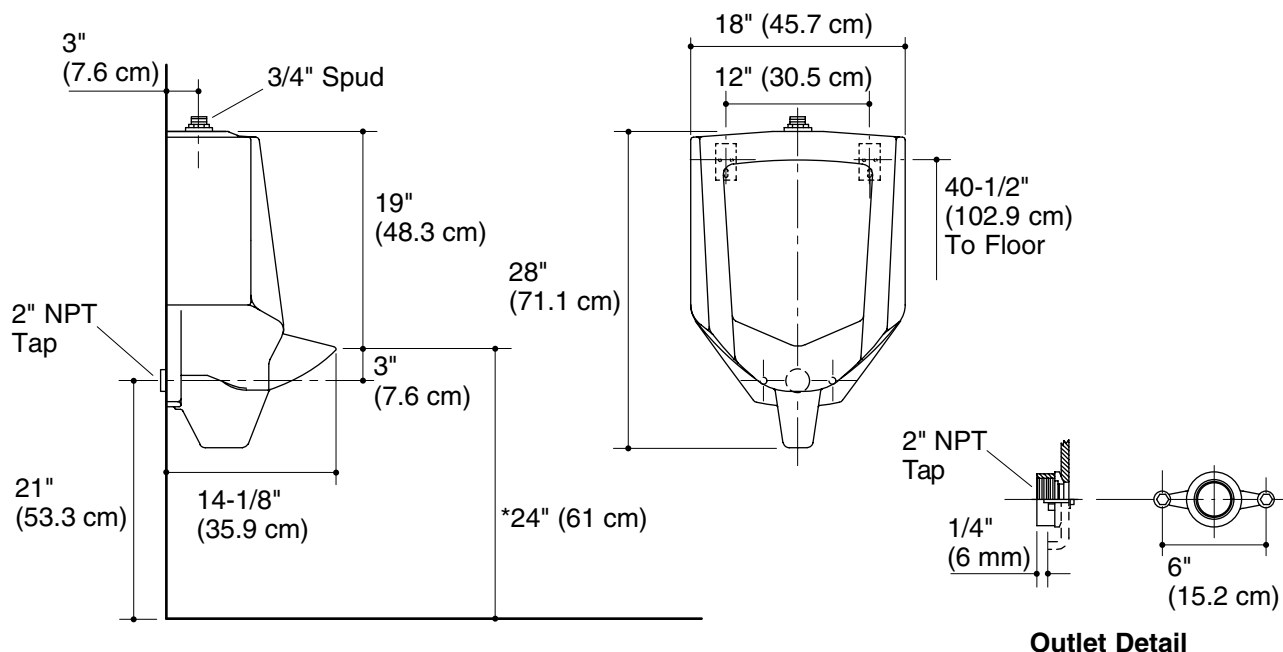

## Product Diagram