

# Hunter®

## Pro-C Controllers

## Pro-C Controllers

*A Complete  
Family of  
Full-featured  
Residential  
and Light  
Commercial  
Controllers*

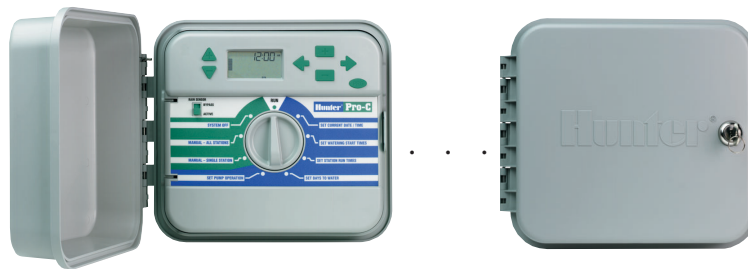

For the end user, for the contractor...there has never been a residential and light commercial controller so remarkably easy to handle as this. Presenting the new Hunter Pro-C Controller. Borrowing the innovative concept of modular design from its big brother, the ICC, this latest addition to the Hunter product line-up is destined to become the leading controller in its market segment in the years to come. Starting with a base model of 3 stations, it is possible to expand the controller up to 12 stations simply by adding plug-in modules. So, there's no need to bring along a variety of different-sized controllers to see which one is best for the job. With its ability to

customize to the particular size you need, the Pro-C will always be the right choice. A modular system also makes inventory a breeze for contractors – there are only three different units to stock (indoor cabinet, outdoor cabinet and station module). But, modularity isn't all this controller has to offer, with great features such as three programs with multiple start times, independent day scheduling options, "one touch" manual start and rapid advance, a programmable event day off, robust heavy-duty locking plastic cabinet, and superior surge protection. The Pro-C controller: delivering maximum flexibility for landscapes that require a minimal number of stations.

### FEATURES & BENEFITS



#### **Versatile modular design**

Simplified inventory management; easily customize unit to desired number of stations

#### **Large LCD display for simplified programming**

Easy to read for schedule review and entry

#### **Three programs (A,B,C) with multiple start times**

Independent programming handles many different watering requirements

#### **Choice of independent day scheduling options**

Days of the week, odd/even or 31-day interval for maximum flexibility

#### **Global water budget/seasonal adjustment**

Easily change run time of all zones from 10% to 150%

#### **Non-volatile memory**

Holds programs indefinitely; excellent insurance against unreliable power

#### **Superior surge protection and self-diagnostic short circuit protection**

Microcircuits are protected from electrical spikes, no fuses to worry about



## Models

- PC-300i – base model indoor plastic cabinet with plug-in 115 VAC transformer, expands to 12 stations
- PC-300 – base model outdoor locking plastic cabinet with 115 VAC transformer, expands to 12 stations
- PCM-300 – 3 station plug in module for use with any PC controller model

## Dimensions

- Indoor Model: 8.3" H x 9.6" W x 3.7" D
- Outdoor Model: 8.9" H x 9.9" W x 4.3" D

## Operating Specifications

- Outdoor models, 115 VAC transformer with internal junction box
- Indoor model, 115 VAC two prong plug-in transformer
- Station output 24 VAC .56 Amps
- Transformer output 24 VAC 1.0 Amps
- Capable of operating equivalent of 3 solenoids simultaneously
- Operating Temperature: 0 - 150 degrees F
- NEMA rated outdoor cabinet
- UL Listed

## Additional Features

- 4 start times per program for repeat watering needs
- Removable front panel for field or desktop programming; Panel interchangeable between indoor and outdoor units
- Up to six hours run time on all stations
- Automated chronological ordering of start times/start time stacking
- 365-day calendar with leap year intelligence
- Programmable event day off allows specific day(s) to be designated as always "off"
- Rain Sensor bypass switch compatible with micro-switch based sensors, displays when sensor is active
- Programmable delay between stations 0-4 hours for well recovery or slow-closing valves
- Programmable rain delay for 1-7 days
- Compatible with Hunter's SRR remote control system and SRP Windows®-based software programming system

## Removable Face Plate: the power of desktop programming is in your hands

If you thought the only way to program a controller was to be standing right in front of it, think again. With the removable face plate on the Pro-C controller, simply detach the face plate of the unit and perform programming functions from a variety of different locations. Take the face plate with you and walk around the yard as you set the program (visiting each different zone as you program it). Program the controller from the comfort of your office before taking it to the customer's site for installation. Or, hand the panel over to your customer during installation and let them sample the programming features.

## Modules: designed to make everything easier

It's designed to fit virtually any residential or light commercial need. It's designed for flexibility right at the job site. It's designed to keep an installer's inventory to a minimum. What is it? It's the modular design of the new Hunter Pro-C controller. Beginning with a 3-station base unit, the Pro-C can be expanded with up to three more 3-station modules. Thus, a contractor no longer needs to stock eight different types of controllers (3-, 6-, 9- and 12-station units in both indoor and outdoor models)...he simply needs to keep on hand just three items (indoor and outdoor Pro-C base units and 3-station modules).



## The flexibility to cover particular program needs

So, your landscape isn't an everyday landscape...as in needs water everyday. Your landscape is a particular one, with its own quirky requirements. The Pro-C is just the controller to handle this little prima donna. No other controller can boast more flexibility in its programming options. Need multiple daily waterings? How about 3 independent programs and 4 start times per program. Deep soaking needs? The Pro-C offers long station run times. Irrigation restrictions in your area? Choose from day of the week, interval watering or true odd/even scheduling. There's even an "event day off" feature that designates specified days of the week for non-watering (perfect for regular maintenance or special events).

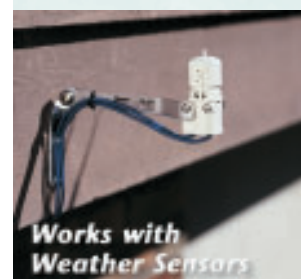

## PRODUCT EXPLANATION

EXAMPLE: **PC - 300i**

MODEL	FEATURES
PC	300i - 3 Station base unit, indoor mount with plug-in transformer expands to 12 stations 300 - 3 Station base unit, outdoor mount, expands to 12 stations

## PRO-C QUICK REFERENCE CHART

Desired Station Configuration	Order Base Unit	Plus Number of modules	Specify as:
3 Zone	PC-300 or PC-300i	no module needed	PC-300i or PC-300
6 Zone	PC-300 or PC-300i	one PCM-300	PC-600i or PC-600
9 Zone	PC-300 or PC-300i	two PCM-300	PC-900i or PC-900
12 Zone	PC-300 or PC-300i	three PCM-300	PC-1200i or PC-1200