

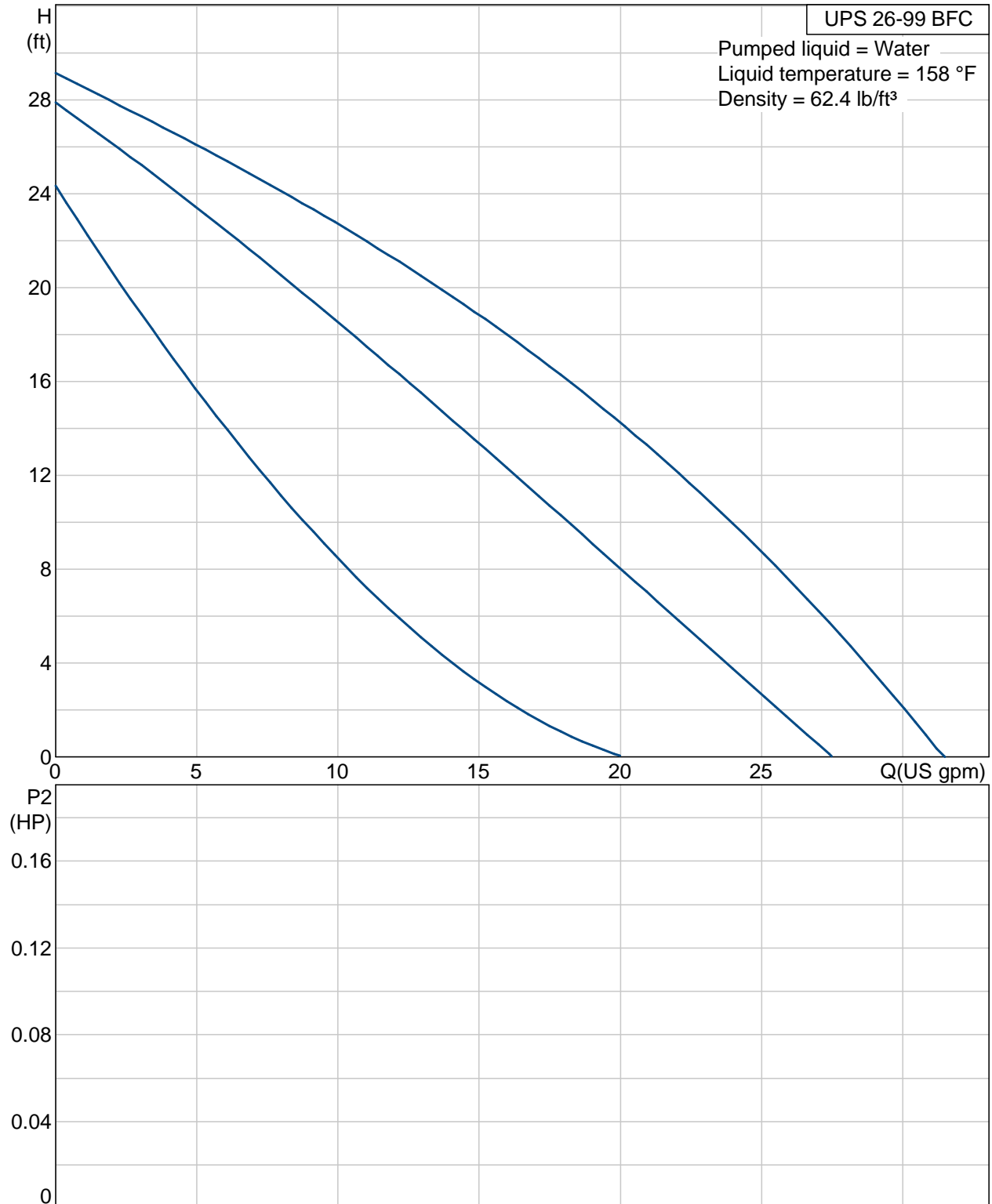

Position	Count	Description	Unit price
	1	<p><b>UPS 26-99 BFC</b></p>  <p>Product photo could vary from the actual product</p> <p>Product No.: 52722518                      The pump is of the canned rotor type, i.e. pump and motor form an integral unit without shaft seal and with only two gaskets for sealing.                      The bearings are lubricated by the pumped liquid.                      The pump is characterized by:</p> <ul style="list-style-type: none"> <li>* Ceramic shaft and radial bearings.</li> <li>* Carbon axial bearing.</li> <li>* Stainless steel rotor can and bearing plate.</li> <li>* Corrosion-resistant impeller, Composite, PES.</li> <li>* Bronzepump housing.</li> </ul> <p>The motor is a 1-phase motor.                      No additional motor protection is required.</p> <p><b>Liquid:</b>                      Liquid temperature range: 35.6 .. 230 °F                      Liquid temp: 158 °F                      Density: 61.01 lb/ft³</p> <p><b>Technical:</b>                      Approvals on nameplate: UL, CSA</p> <p><b>Materials:</b>                      Pump housing: Bronze                                        DIN W.-Nr. 2.1176.01                      Impeller: Composite, PES</p> <p><b>Installation:</b>                      Maximum ambient temperature: 104 °F                      Ambient max at 176°F liquid: 176 °F                      Maximum operating pressure: 145 psi                      Flange standard: USA Oval                      Type of connection: Bronze Flange                      Pipe connection: 2 - Bolt Flange                      Pressure stage: 10                      Port-to-port length: 6 1/2 in</p> <p><b>Electrical data:</b>                      Number of poles: 2</p>	On request

Position	Count	Description	Unit price
		Power input in speed 1: 150 W	
		Power input in speed 2: 179 W	
		Max. power input: 197 W	
		Rated power - P2: 0.161 HP	
		Main frequency: 60 Hz	
		Rated voltage: 1 x 115 V	
		Current in speed 1: 1.3 A	
		Current in speed 2: 1.5 A	
		Current in speed 3: 1.8 A	
		Capacitor size - run: 20 µF/180 V	
		Insulation class (IEC 85): F	
		<b>Others:</b>	
		Gross weight: 10.3 lb	

**52722518 UPS 26-99 BFC 60 Hz**



52722518 UPS 26-99 BFC 60 Hz

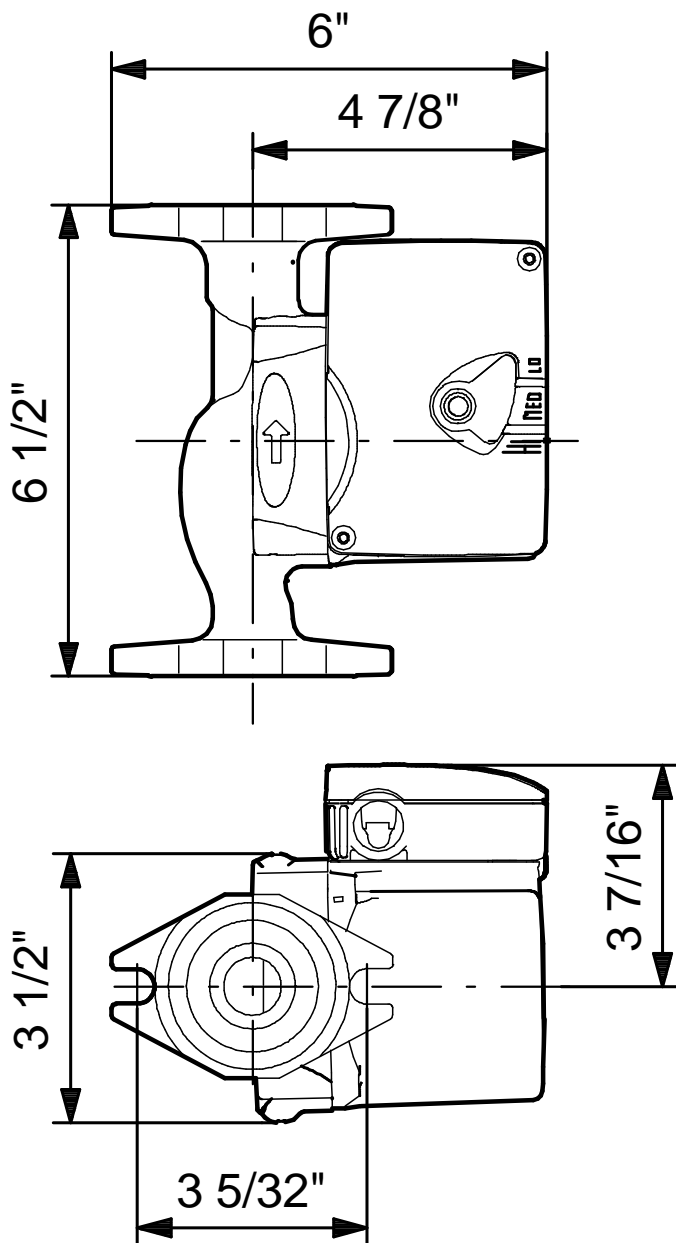

Note! All units are in [mm] unless others are stated.  
Disclaimer: This simplified dimensional drawing does not show all details.