

ELKAY[®]

SPECIFICATIONS

Push Lever Glass Filler Model LK1110

GENERAL

K1110 stainless steel single water gooseneck glass filler, manufactured with 100% lead-free material, plastic push lever control, 8-1/4" (210mm) high overall, 3/8" NPT connection. Ship. Wt. 1 lb.

DIMENSIONS

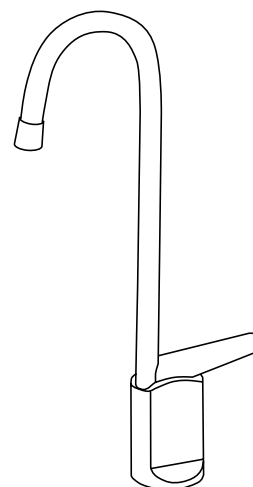
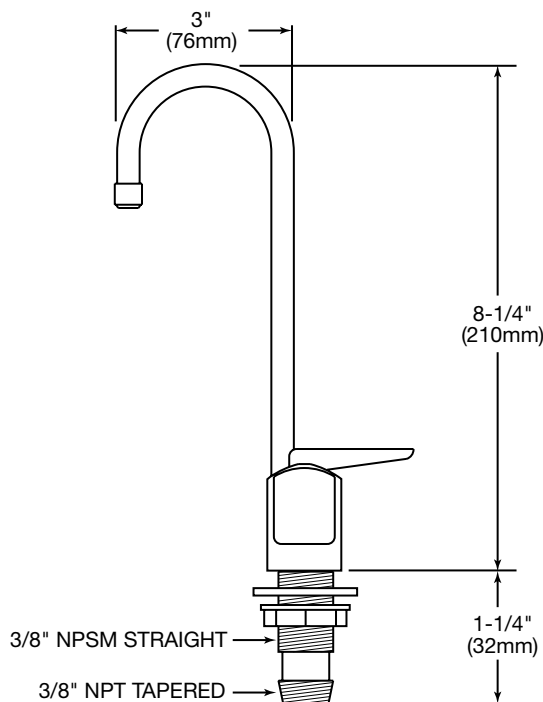

Model LK1110

PARTS LIST

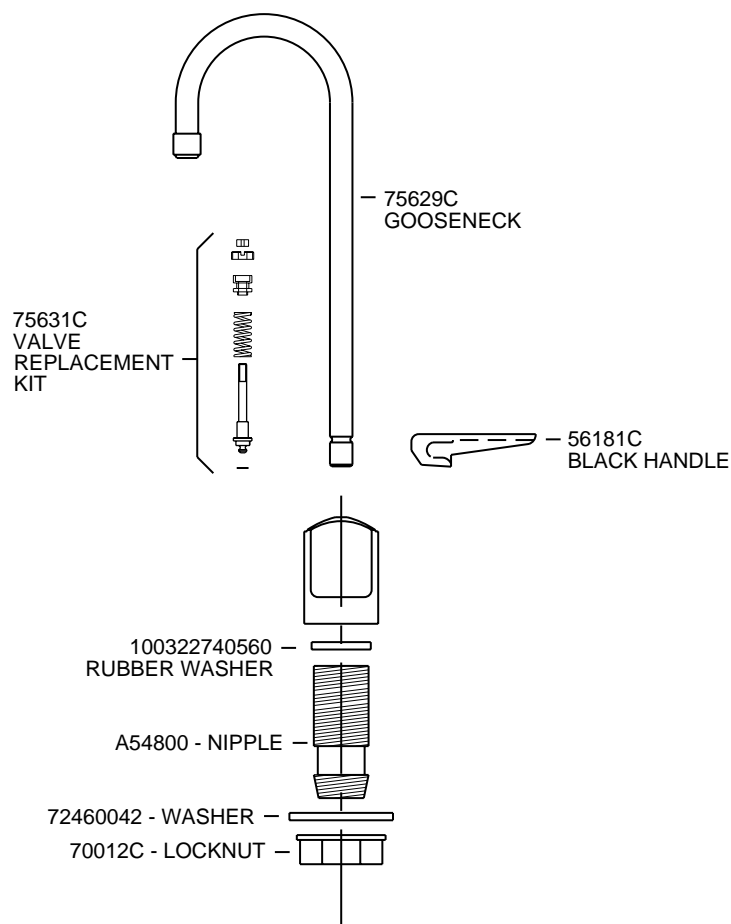

In keeping with our policy of continuing product improvement, Elkay reserves the right to change product specifications without notice.

This specification describes an Elkay product with design, quality and functional benefits to the user. When making a comparison of other producers' offerings, be certain these features are not overlooked.