



## SPECIFICATIONS

### GENERAL SPECIFICATIONS

The backflow preventer shall be a Double Check Valve type including four (4) resilient-seated test cocks and two (2) resilient-seated gate valves.

The two (2) check valves shall be independently acting and internally loaded. Each check valve shall maintain a minimum of 1 psid in the normal direction of flow, under static conditions.

Both check valves and all test cocks shall be top-mounted for ease of testing, repair and maintenance.

The backflow preventer shall be suitable for **supply pressure up to 175 psig and water temperatures from 33 to 180° F.**

The backflow preventer shall meet the requirements of the following standards: **USC's FCCC & HR Manual, Sec. 10, ASSE 1015, AWWA C-510 and CSA B64.5.**

### CONBRACO SPECIFICATIONS

A Double Check Valve backflow preventer shall prevent backflow by either backpressure or back-siphonage from a cross-connection between potable water lines and substances that are objectionable, but not a health hazard.

It shall consist of two (2) mechanically independent, spring loaded, poppet type check valves set in an integral cast bronze body. Both check valves shall be top entry design to provide easy access during repair and maintenance.

The assembly shall have four (4) top-mounted test cocks and two (2) shut-off valves which are quarter turn, full port, resilient seated and ball type. **The seat of each check valve shall be replaceable.**

The loading of each check valve poppet assembly shall be accomplished by a stainless steel compression spring retained in position by a threaded bronze cover. The cover shall serve as access for easy repair and maintenance without removing the assembly from the line. Poppet assemblies, springs and covers shall be interchangeable.

All parts shall be made of corrosion resistant materials and shall be **100% made in the USA.**

The backflow preventer shall be suitable for supply pressure up to **175 psig and water temperatures from 33 to 180° F.**

The backflow preventer shall be listed or approved under the following standards: **USC's FCCC & HR Manual, Sec. 10, ASSE 1015, AWWA C-510, and CSA B64.5.**

The manufacturing facility shall be **ISO 9001 REGISTERED.**

The backflow preventer shall be manufactured by **CONBRACO INDUSTRIES, INC.,** Matthews, North Carolina.

## TOP ENTRY - TOP TESTABLE Double Check Valve Assembly

Sizes 3/4" - 1" - 1 1/4" - 1 1/2" - 2"



## FEATURES

- Top access for testing, repair and maintenance
- Corrosion Resistant
- Low head loss
- Interchangeable poppets and springs
- Replaceable seats
- Compact and lightweight
- Comes standard with Apollo® full port ball valves
- Maximum working pressure 175 psig
- Operating Temperature Range 33-180° F

## APPROVALS

The Series 40-100 Top Entry is approved under **USC's FCCC & HR Manual, Sec. 10, ASSE 1015, AWWA C-510, and CSA B64.5.**



# FLOW CURVES WITH BALL VALVES

(•) Rated flow as determined by USC's FCCC & HR and ASSE design performance standards.

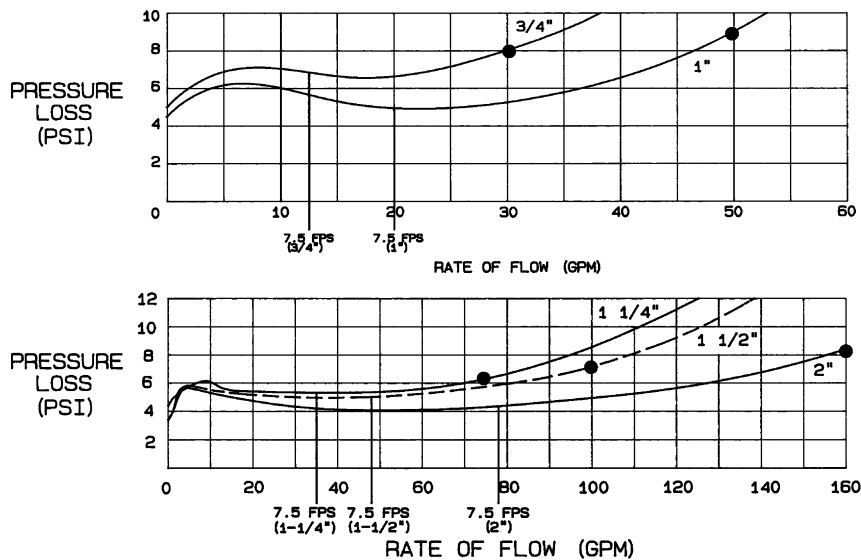

## DIMENSIONS (in.) – WEIGHTS (lbs.)

Body Size	3/4"	1"	1-1/4"	1-1/2"	2"
A	14-1/4	14-3/4	20-3/4	21-3/8	23-1/8
B	7-1/4	7-1/4	12-3/8	12-3/8	12-3/8
C	4-5/16	4-5/16	6-1/8	6-1/8	6-1/8
D	1-5/8	1-7/8	2-3/16	2-5/8	3
E	2-7/16	2-7/16	3-13/16	3-13/16	3-13/16
F	5-7/16	5-7/16	6-3/8	6-3/8	6-3/8
G	13/16	13/16	1-3/8	1-3/8	1-3/8
Test Cocks	1/8x1/4 NPT	1/8x1/4 NPT	1/4x1/4 NPT	1/4x1/4 NPT	1/4x1/4 NPT
Net Wt.	8.8	9.5	23.2	25.7	31.5
Shipping Wt.	10.1	10.8	25.9	28.8	35.5

NOTE: Weights do not include strainer. Strainer shipped loose.

\*Strainer optional. Contact representative for details.

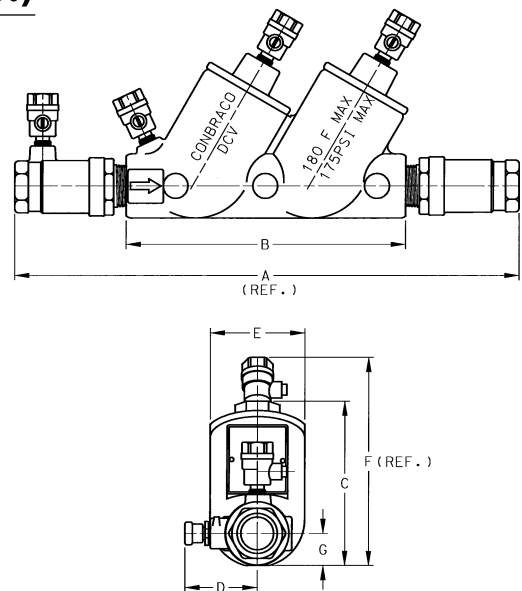

## MATERIALS

- |                      |                     |
|----------------------|---------------------|
| 1. Body & Covers     | Bronze              |
| 2. Springs           | Stainless steel     |
| 3. Poppet            | Glass-filled acetal |
| 4. Seat Discs        | Silicone rubber     |
| 5. Replaceable seats | Glass-filled ppo    |
| 5. Fasteners         | Stainless steel     |

## ORDERING NUMBERS

40-1XX-TX		
0 - Standard	4 - 3/4"	1 - Less valves
1 - w/ Y-strainer (shipped loose)	5 - 1"	2 - With ball valves
	6 - 1-1/4"	4 - With union end ball valves
	7 - 1-1/2"	
	8 - 2"	

For UL Classified (3/4" - 2")

FP1- Less ball valves

FP2- w/ball valves

## BACKFLOW PRODUCTS DIVISION

Conbraco Industries, Inc. P.O. Box 247 Matthews, N.C. 28106 (704) 841-6000 FAX (704) 841-6020-USA