



— SERIES — **501A**

Wafer Swing Check Valve



Materials

Valve Body:

2" - 12" Cast Iron ASTM A48
Electroless-Nickel Plated
14" - 30" Carbon Steel ASTM A216 WCB
Electroless-Nickel Plated

Valve Trim:

2" - 12" 316 Stainless Steel ASTM A23,
14" - 30" Carbon Steel ASTM A216 WCB
Electroless-Nickel Plated
Seat O-ring: Nitrile, Other Seat Materials Available

Options:

All 316 Stainless Steel Available in 2"-12"

- Low Head Loss
- Watertight Nitrile Seat
- Spring Assisted Fast Closure
- Extremely Light Weight
- 316 SS Body Trim Available

Cla-Val Series 501A Wafer Swing Check Valve has a quick, spring-assisted closure that minimizes the possibility of water hammer. The swing check design offers low head loss and a full-flow passageway making it ideal for water or waste-water applications. The short lay length of the valve allows for a space-saving design. It is available in sizes 2" to 30", with either a 125 lb. or 150 lb. pressure class rating.

Available in a variety of materials, including all 316 stainless steel, the Cla-Val Wafer Swing Check Valve uses a standard soft seat to ensure a drip-tight seal. For ease of installation, valves 6" and larger are supplied with a tapped hole to mount an eye bolt for lifting. All materials conform to ASTM specifications, ensuring performance reliability.

SPECIFICATIONS

The wafer swing check valve shall have a spring-assisted closure that minimizes the possibility of water hammer. The valve shall be constructed of either cast iron or carbon steel.

For corrosion resistance the valve shall be Electroless Nickel Plated. The valve shall be a Cla-Val Series 501A Wafer Swing Check Valve.

Typical Applications

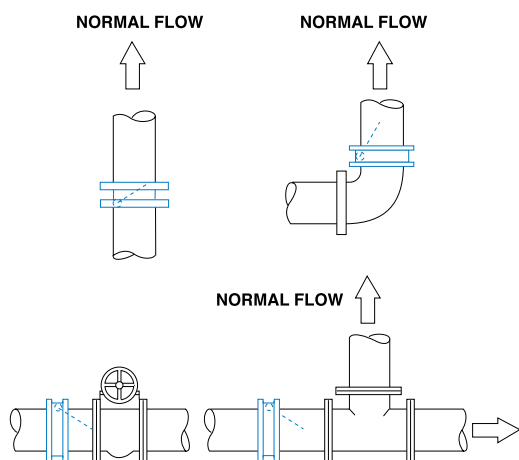

Avoid These Applications

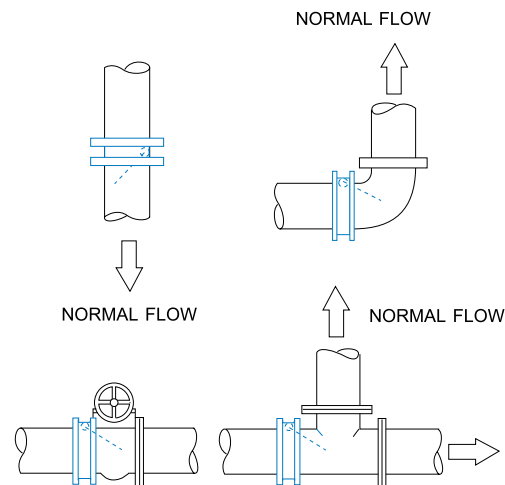

Wafer Swing Check Valve

Series 501A

Dimensions (In Inches)

Size	A	B	C	D	Wt Lbs.
2	4 ¹ / ₈	1 ¹¹ / ₁₆	1 ³ / ₈	1 ¹³ / ₁₆	3.1
2 1/2	4 ⁷ / ₈	1 ¹³ / ₁₆	1 ³ / ₄	1 ¹ / ₁₆	4.2
3	5 ³ / ₈	2 1/2	2 ³ / ₈	1 ¹ / ₈	6.6
4	6 ³ / ₄	2 1/2	3 ¹ / ₈	1 ⁵ / ₈	8.1
5	7 ³ / ₄	2 ³ / ₄	3 ⁷ / ₈	2 1/2	12.3
6	8 ³ / ₄	3	4 1/2	3 ³ / ₄	18
8	11	3 1/2	6 1/4	4 ³ / ₄	27.3
10	13 ³ / ₈	4 1/2	7 ⁵ / ₈	5 ³ / ₄	51.3
12	16 ¹ / ₈	4 1/2	9 1/2	7 ³ / ₈	72.6
14*	17 ³ / ₈	1 1/2	10 ³ / ₈	10	88
16*	20 ¹ / ₄	1 ⁷ / ₈	12	11 1/2	128
18*	21 ⁵ / ₁₆	1 ⁷ / ₈	13 ⁷ / ₈	12 ³ / ₈	152
20*	23 1/2	2 1/4	15 ⁷ / ₈	13 1/2	242
24*	28 1/4	2 ⁷ / ₈	19 1/8	15 1/2	356
30*	34 ³ / ₄	3	24 ⁷ / ₈	19 ³ / ₈	638

*(Flat Faced)

Note: For Cement Lined Pipe Applications-Contact the Factory for Dimensions.

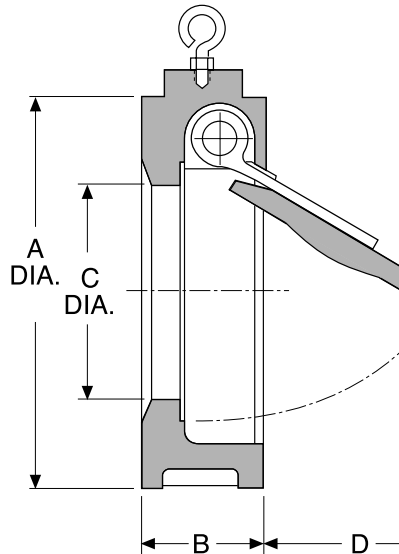

Pressure Rating: 235 Max psi

Temperature Range: -5° to 210°F

Fluids: Water, Petroleum, Chemicals and Wastewater

Note: 14" - 30" Have integral O-Ring Flanged Seals. Gaskets are not required for installation and should not be used.

Series 501A Pressure Loss Curve

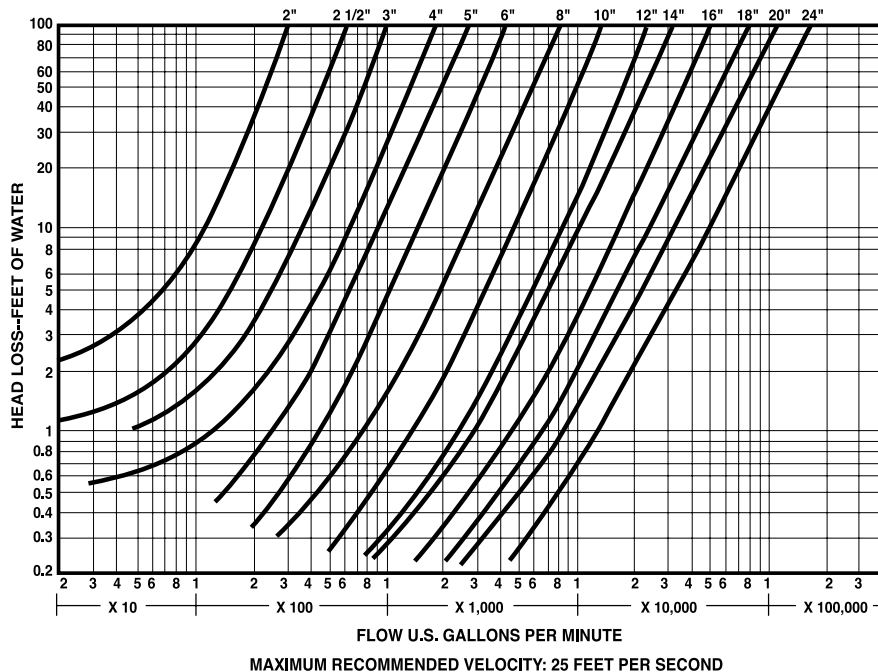

When Ordering, Please Specify

1. Catalog No. 501A
2. Valve Size
3. Trim Material
4. Desired Options
5. When Vertically Installed

**** 30" Consult Factory**

Valve Size	Inches	2"	2-1/2"	3"	4"	5"	6"	8"	10"	12"	14"	16"	18"	20"	24"	30"
	mm	50	65	80	100	125	150	200	250	300	350	400	450	500	610	750
CV Factor	Gal/Min	61	116	208	325	551	843	1640	2702	3996	5732	8548	11846	14327	22132	**
	Litres/Sec	3.85	7.32	13.12	20.5	34.76	53.18	103.47	170.47	252.11	361.63	539.29	747.36	903.89	1396.31	**



E-501A (R-11/01)

CLA-VAL

PO Box 1325 Newport Beach CA 92659-0325
Phone: 949-722-4800 • Fax: 949-548-5441

CLA-VAL CANADA, LTD.

4687 Christie Drive
Beamsville, Ontario
Canada LOR 1B4
Phone: 905-563-4963
Fax: 905-563-4040

© COPYRIGHT CLA-VAL 2001 Printed in USA
Specifications subject to change without notice.

CLA-VAL SA

Chemin des Mesanges 1
CH-1032 Romanel/
Lausanne, Switzerland
Phone: 41-21-643-15-55
Fax: 41-21-643-15-50

www.cla-val.com

Represented By: