

TAPE LOC™ FITTINGS

For Use With All Drip Tape Products

DURABLE

RELIABLE

PROVEN

TRUSTED

Applications

Agriculture



Landscape



Nursery



Product Features

Agricultural Products Tape Loc™ fittings are designed to provide tight, fast, reliable leak proof connections on thin wall tape and tape-like products.

For maximum strength and chemical resistance the body is molded from PVC or Polypropylene with 2% carbon black added. The lock ring is manufactured using glass-reinforced polypropylene for maximum strength and durability.

- Extensive fitting line, largest selection of configurations for all major brands.
- Available in 3/8", 5/8", 7/8", and 1 3/8" sizes to fit all major brands.
- Easy take-off connections to Flatube®, Layflat or PVC.
- Time tested durability for superior in-field performance.
- Re-usable year after year.
- Chemical, UV and heat resistant.
- Made in the U.S.A.
- Fits most 4 mil. to 25 mil. tapes.



Tape Loc™ Fitting to Tape Installation

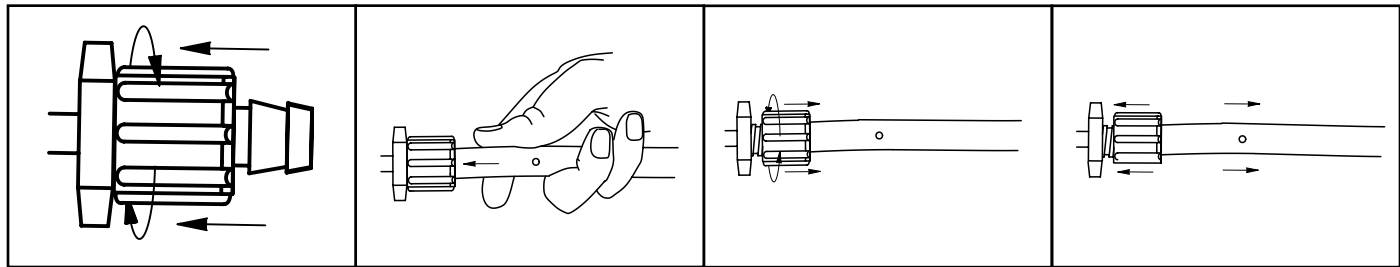

1. Turn sleeve until it moves back tightly against stop and barb is fully exposed

2. Push tape over barb and as far as possible into sleeve opening

3. Turn sleeve counter clockwise until it slides out and fits tightly onto the tape

4. Pull fitting & tape firmly in opposite directions to insure that you have achieved a tight connection

Installing Barb End Fittings In API Flatube

400B-06-LS

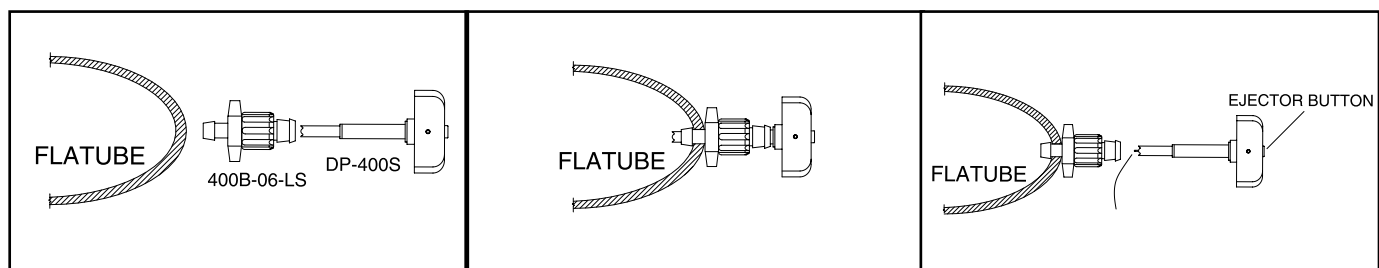

1. Insert punch into barbed fitting.

2. Push and twist to pop barb into API Flatube

3. Remove punch and eject cutout by pushing the ejector button

700B-06-LS & 700B-09-LS

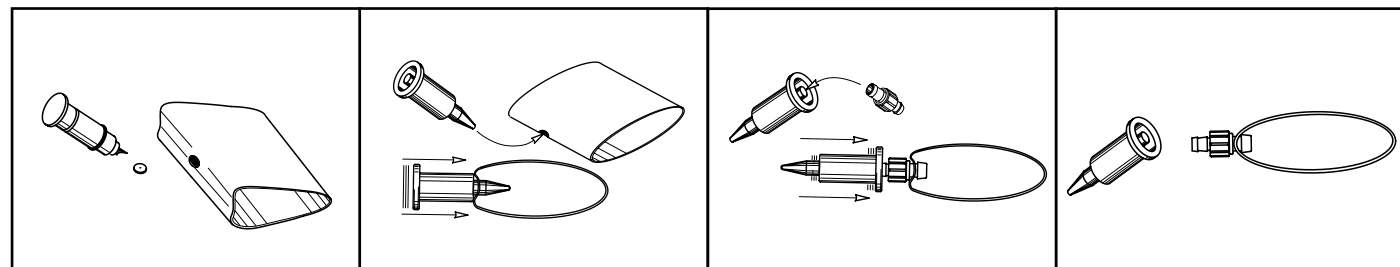

1. Use DP-700-KIT punch to cut hole for fitting in Flatube.

2. After cutting hole in Flatube, push point of flaring and insertion tool into hole to relax and temporarily enlarge opening.

3. Nest fitting or plug onto inner shaft in body of tool, then push barb end into previously enlarged opening in Flatube

4. Remove tool. Fitting or plug is now securely locked in Flatube.

Installing Tape Loc™ Fittings Into Layflat

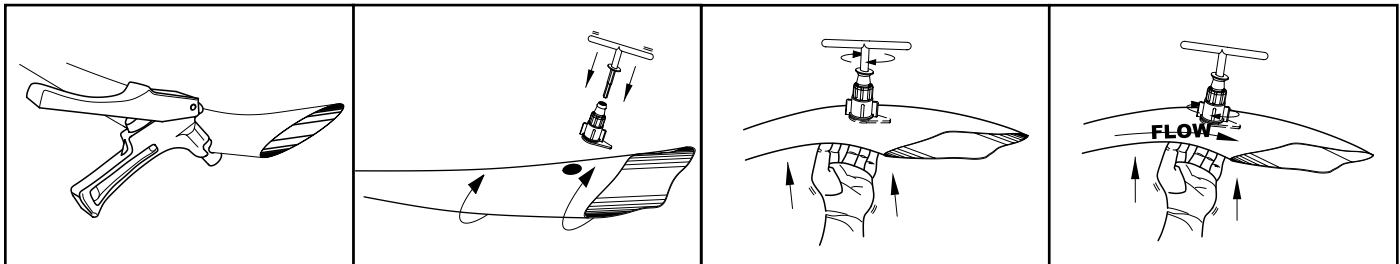

1. Punch hole at foldline in layflat with the appropriate punch. Layflat fold must be fully inserted into the slot of the punch.

2. Orient the hose so that the hole is in the center of the flattened area. Insert Tee-Handle into center hex of the fitting.

3. Hook bottom of teardrop into the hole in the Layflat. Twist Tee-Handle while pushing against backside of fitting with the other hand to prevent fitting from backing out.

4. While holding the Tee-Handle, tighten 'Eared' locking collar until snug on the hose. Teardrop on the bottom of the fitting should be orientated with direction flow.



Tape Loc™ Fitting Connections For Barb Ends

Tape Loc™ Connection	Hole Size	Installation/Cutting Tools	Hole Plugs
250 Barb to Poly	1/8"	DP-E1G	MP-1
400 Barb to Poly	1/4"	DP-400 / DP-400S	MP-400
420 Barb to Poly	5/16"	DP-420	MP-400
425 Barb to Poly (high density)		425BG-Drill	MP-700
700 Barb to Poly	7/16"	DP-700 Kit	MP-700
400 Barb to PVC (use 400-GRO)	9/16"	400B-Drill	MP-400GRO
700 Barb to PVC (use 700-GRO)	13/16"	700B-Drill	MP-700
1000 Barb to PVC (use 1000-GRO)	1 5/16"	1 5/16" Drill Bit	1000 PIA w/PVC Cap

PVC Pipe to Tape Connections

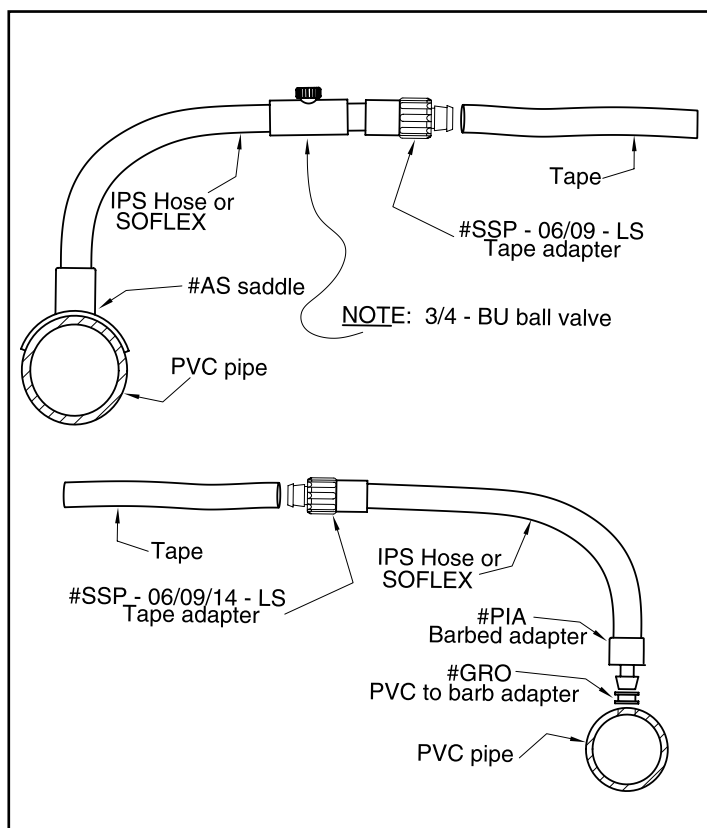

Flatube to Tape Connections

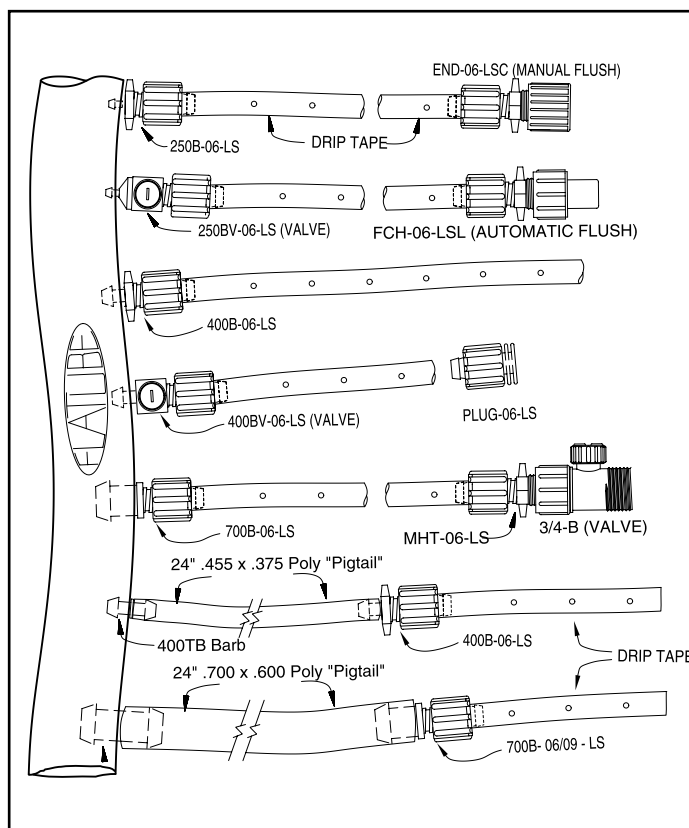

Quick Guide: Tape Loc™ Fittings

Tees

TEE-06-LS



TEE-06-LSL 1/2
TEE-06-LSL 3/4



TEE-06-LSL

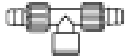

TEE-06-LSB 250
TEE-06-LSB 400
TEE-06-LSB 700



LST-06-LS
LST-06 w/washer
or w/screen



TEE-06-MHT
TEE-06-MPT

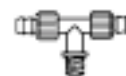

Wye

WYE-06-MHT
or
WYE-06-MPT

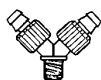

Ells

ELL-06-LS



ELL-06-MHT
ELL-06-MPT



Couplers

CPT-04-LS
CPT-06-LS
CPT-09-LS
CPT-14-LS



CPTBV-06-LS



Adapters

SSP-06-LS
SSP-09-LS
SSP-09-LS1
SSP-09-LS2
SSP-14-LS2



CSP-06-LS
CSP-09-LS



FHC-04-LS
FHC-06-LS
FHC-09-LS



250B-04-LS
250B-06-LS



400B-04-LS
400B-06-LS



250-BV-06-LS
400-BV-06-LS



420-BV-06-LS



425-BG-04-LS
425-BG-06-LS

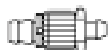

FHS-04-LS
FHS-06-LS
w/screen or
w/ washer



MHT-04-LS
MHT-06-LS
MHT-09-LS



BSP-06-LS



700B-06-LS
700B-09-LS



1000B-14-LS



MA-04-LS
MA-06-LS
MA-09-LS



MA-09-LS1
MA-14-LS1

Ends

END-04-LSC
END-06-LSC
END-09-LSC



PLUG-04-LS
PLUG-06-LS



*FCH-04-LS
*FCH-06-LS
*FCH-09-LS



Note: Some of the above fittings are custom made and are not stocked.

*Low (L) 0.6 GPM require to close; reopens when pressure falls below 1 psi (white plunger)

*High (H) 0.8 GPM require to close; reopens when pressure falls below 2 psi (orange plunger)



P.O. Box 3760 - Ontario, CA 91761 800.828.9919 - Fax: 800.777.6162
P.O. Box 3546 - Haines City, FL 33845 - 800.848.8153 - Fax: 800.533.6421
8020 W. Doe Ave. - Visalia, CA 93291 - 559-651-3221 - Fax: 559-651-3207
Visit us at: www.agproducts.com

Copyright 2003 Agricultural Products, Inc.
All rights reserved.

