

Installation Guide

Touchless Urinal

K-4915

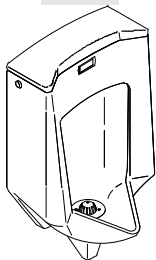

M product numbers are for Mexico (i.e. K-12345**M**)

Los números de productos seguidos de

M corresponden a México (Ej.

K-12345**M**)

Français, page "Français-1"

Español, página "Español-1"

THE BOLD LOOK
OF **KOHLER**®

1020643-2-E

Tools and Materials



Safety Glasses



Tape Measure

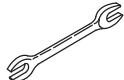

5/8" Wrench



Adjustable Wrench

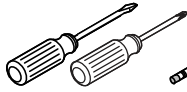

Assorted Screwdrivers



Pencil

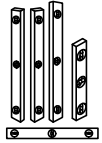

Levels



Thread Sealant

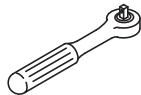

1/4" Ratchet

Plus:

- Hole Cutting Equipment

Before You Begin



CAUTION: Risk of personal injury. Handle this product with care. Vitreous china can break or chip if the product is handled carelessly.

NOTE: Roughing-in remains the same when using the optional 3" outlet spud.

- ☐ Observe all local plumbing and building codes.
- ☐ Refer to local codes and manufacturer's instructions for flush valve requirements.
- ☐ Carefully inspect the new urinal for damage.
- ☐ Fixture dimensions are nominal and conform to tolerances by ASME Standard A112.19.2/CSA B45.1.
- ☐ Site preparation may require additional tools and hardware.

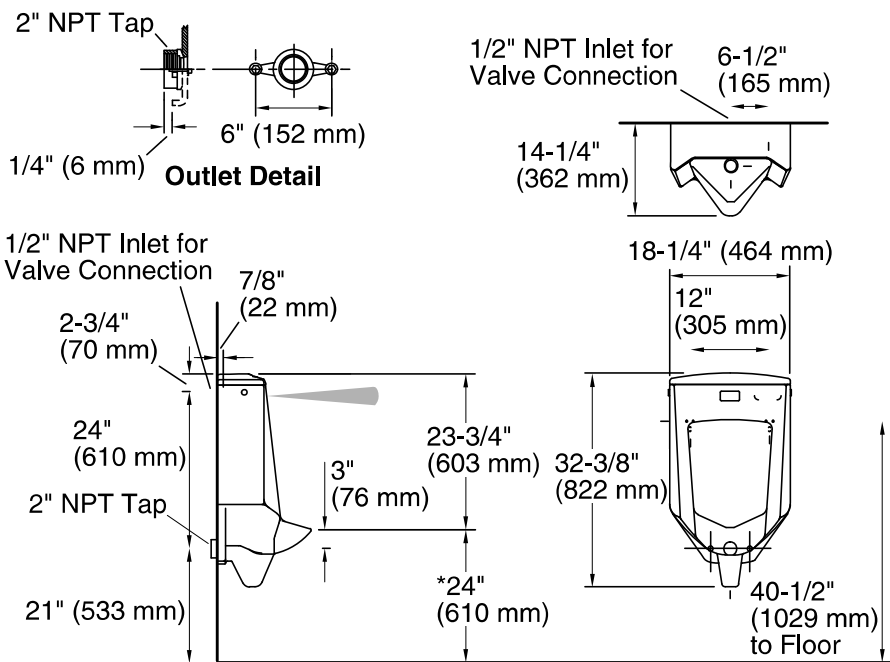

Roughing-In

- Roughing-in remains the same when using the optional 3" outlet spud.
- *The urinal complies with ADA requirements when the rim is mounted no higher than 17" (430 mm) from the finished floor.

1. Prepare the Site

- ☐ Turn the water supply off.
- ☐ Install or relocate the waste pipe as necessary to conform to the roughing-in dimensions.
- ☐ Install the shut-off valve.
- ☐ Install adequate support framing for the wall hangers as needed.

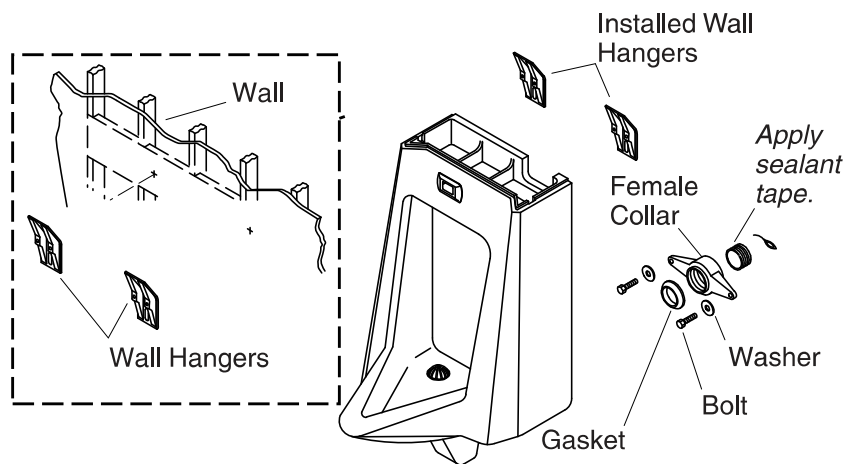

2. Install the Urinal



CAUTION: Risk of personal injury. Handle with care. Vitreous china can break or chip if the product is handled carelessly.

- Install the wall hangers according to the roughing-in illustration.
- Apply thread sealant tape to the pipe threads on the drain and install the collar to the drain.
- With the beveled surface of the gasket facing away from the collar, place the gasket onto the collar.
- Carefully position the urinal on the wall hangers.

CAUTION: Risk of product damage. Do not overtighten the bolts.

- Secure the urinal to the collar using the washers and bolts provided.

NOTE: Do not caulk the top surface of the urinal. Caulk may prevent the tank cover from seating properly.

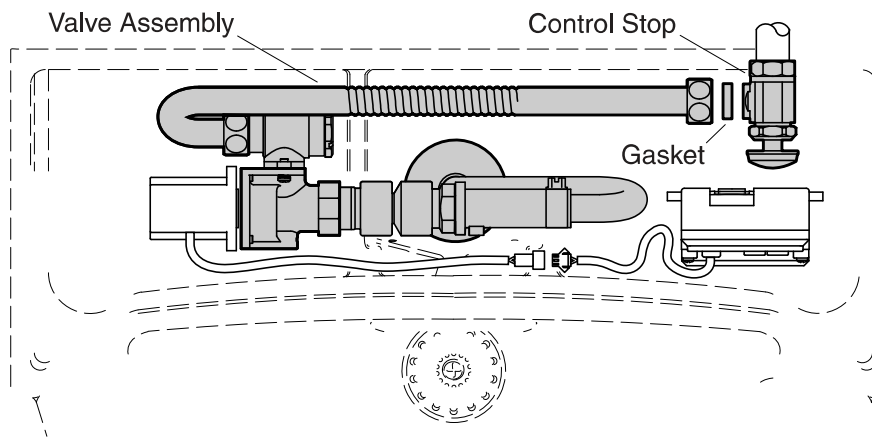

3. Install the Valve Assembly

- Using thread sealant tape, wrap the end of the water supply line.

IMPORTANT! When disconnecting the control stop from the valve assembly, the gasket will fall out from the end of the valve assembly. Retain the gasket.

- Disconnect the control stop from the valve assembly. Retain the gasket from the valve assembly.
- Attach the control stop to the water supply line.
- Reinsert the gasket into the end of the valve assembly.
- Reconnect the control stop to the valve assembly.

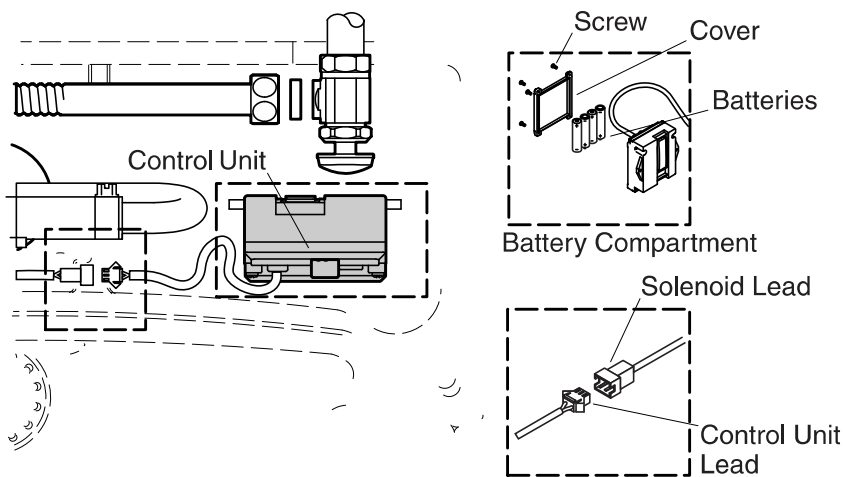

4. Complete the Installation

Connect

- ☐ Using a Phillips screwdriver, remove the four screws from the cover of the battery compartment. Set the four screws and cover aside.
- ☐ Install four AA alkaline batteries into the battery holder assembly.
- ☐ Reinstall the cover to the battery compartment.
- ☐ Plug the solenoid lead into the control unit lead. Wait 10 minutes before proceeding.

Test

- ☐ Stand in front of the urinal for at least 10 seconds.
- ☐ Step aside from the urinal. The valve will flush after a slight delay.

Checkout

- ☐ Check the entire installation for leaks.
- ☐ Repair as needed.
- ☐ If cover locks will not be installed, place the cover on the tank. If cover locks will be installed, proceed to the "Install the Cover Locks" section.

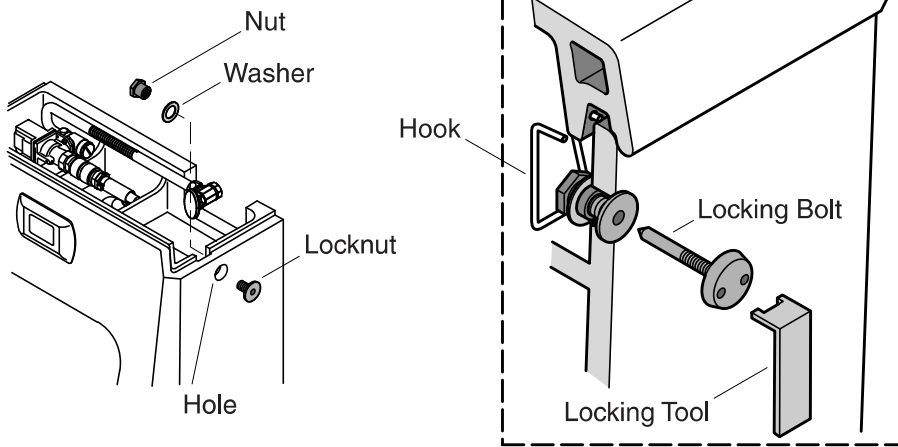

5. Install the Cover Locks

- If present, remove the cover from the tank. Set the cover upside down on a protected surface.
- From the inside of the tank, insert a washer followed by a nut into the hole located on the side of the tank.
- From the outside of the tank, insert a locknut into the hole and through the nut.

CAUTION: Risk of product damage Do not overtighten the locknut.

- Using a 5/8" wrench, tighten the locknut. Do not overtighten the locknut.
- Repeat the above procedures for the other side of the tank.
- Attach a hook to each side of the cover as shown.
- Place the cover on the tank.
- Insert a locking bolt into each locknut.
- Using the locking tool (provided), tighten the locking bolts.
- Lift up on the cover to verify the cover is properly locked. Adjust the cover lock components, if necessary.